

MPC 12/17/10 7035**Weidmüller Interface GmbH & Co. KG**

Klingenbergstraße 26

D-32758 Detmold

Germany

www.weidmueller.com**Similar to illustration**

Abbildung ähnlich

Small and medium-sized polycarbonate enclosures

The polycarbonate enclosures of the MPC series are ideal for building into electrical, electromechanical and pneumatic devices as well as PCBs. The enclosures are used in situations with extreme mechanical and chemical conditions.

Features:

- 17 sizes in 2 versions
- Grey or transparent cover
- Cover with lead-seal holes
- Mounting holes outside the seal area
- Receptacle threads for rail mounting, mounting plates and circuit board
- Comprehensive accessories
- Weidmüller can manufacture and supply the enclosure to match customer specifications, fitted with all necessary terminals and cable glands.

General ordering data

Version	MPC (polycarbonate empty enclosure), Empty enclosure, Height: 125 mm, Width: 175 mm, Depth: 100 mm, Material: Polycarbonate, untreated, Light Grey
Order No.	9535310000
Type	MPC 12/17/10 7035
GTIN (EAN)	4032248009206
Qty.	1 pc(s).

MPC 12/17/10 7035

Weidmüller Interface GmbH & Co. KG

Klingenbergstraße 26

D-32758 Detmold

Germany

www.weidmueller.com

Technical data

Dimensions and weights

Depth	100 mm	Depth (inches)	3.937 inch
Height	125 mm	Height (inches)	4.921 inch
Width	175 mm	Width (inches)	6.89 inch
Net weight	446.8 g		

Temperatures

Operating temperature	-50 °C...130 °C
-----------------------	-----------------

Cable glands, right

M12	6	M16	4
M20	4		

Cable glands, top/bottom

M12	4	M16	3
M20	3		

General information

Access opening: height	121.5 mm	Access opening: width	171.5 mm
Areas of use	Building systems and technology, Transportation, Packaging industry, Machine construction	Enclosure attachment	
Flange plate	No	Impact resistance	Holes 4.5 mm IK08
Installation advice	Screw mounting	Integral fixing	thanks to self-tapping screws
Lid	Yes	Lid attachment	4 polyamide crosshead screws
Material	Polycarbonate	Material thickness	3.5 mm
Number of lid screws	4	Operating temperature, max.	130 °C
Operating temperature, min.	-50 °C	Protection degree	IP66, IP67
Seal material	Polyurethane	Surface finish	untreated
Torque for lid screws	0.8 Nm		

horizontal assembly

WDU 10 / ZDU 10	1x11	WDU 16 / ZDU 16	1x5
WDU 2,5 / ZDU 2,5 / IDU 2,5	1x22	WDU 35 / ZDU 35	1x4
WDU 4 / ZDU 4	1x19	WDU 6 / ZDU 6	1x14

vertical assembly

WDU 10 / ZDU 10	1x11	WDU 16 / ZDU 16	1x9
WDU 2,5 / ZDU 2,5 / IDU 2,5	1x22	WDU 35 / ZDU 35	1x7
WDU 4 / ZDU 4	1x19	WDU 6 / ZDU 6	1x14

MPC 12/17/10 7035**Weidmüller Interface GmbH & Co. KG**

Klingenbergstraße 26

D-32758 Detmold

Germany

www.weidmueller.com**Technical data****Classifications**

ETIM 6.0	EC000261	ETIM 7.0	EC000261
ETIM 8.0	EC000261	ETIM 9.0	EC000261
ECLASS 9.0	27-18-01-01	ECLASS 9.1	27-18-92-90
ECLASS 10.0	27-18-01-01	ECLASS 11.0	27-18-01-01
ECLASS 12.0	27-18-01-01	ECLASS 13.0	27-18-01-01

Environmental Product Compliance

REACH SVHC /

Approvals

ROHS Conform

Downloads

Approval/Certificate/Document of Conformity	EU Declaration of Conformity - MPC Empty Enclosures - DoC DE PS2420 201008 001ISS00 EU Declaration of Conformity - Klippon K Terminal Box - DoC DE PS270X 160308 002ISS03
Engineering Data	CAD data – STEP
Catalogues	Catalogues in PDF-format
Brochures	

MPC 12/17/10 7035

Weidmüller Interface GmbH & Co. KG
Klingenbergstraße 26
D-32758 Detmold
Germany

www.weidmueller.com

Drawings

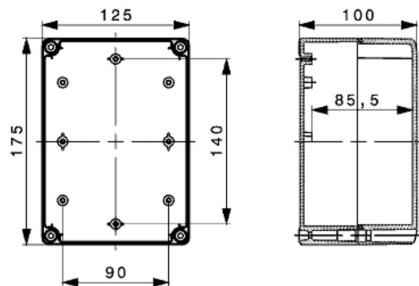

MPC 12/17/10 7035**Weidmüller Interface GmbH & Co. KG**

Klingenbergstraße 26

D-32758 Detmold

Germany

www.weidmueller.com**Accessories****Fixing Material**

Accessories

**General ordering data**

Type	SC MPC	Version
Order No.	9535640000	MPC (polycarbonate empty enclosure), Mounting screw, Screws,
GTIN (EAN)	4032248009428	Height: 12.5 mm, Width: 7 mm, Depth: 12.5 mm, Material: Steel,
Qty.	100 pc(s).	galvanised

TS 35

Accessories

**General ordering data**

Type	TS35X7.5 ST MPC1725 VER	Version
Order No.	8000037600	Rail, TS 35, TS 35 x 7.5, Width: 90 mm, without slot, Steel, galvanic
GTIN (EAN)	4050118653120	zinc plated and passivated
Qty.	20 pc(s).	

MPC 12/17/10 7035**Weidmüller Interface GmbH & Co. KG**

Klingenbergstraße 26

D-32758 Detmold

Germany

www.weidmueller.com**Accessories****Screws**

Depending on the terminal block or also accessories, we offer different types of screws as additional items or also spare parts.

General ordering data

Type	FKSC M4X6 D8/SW2	Version
Order No.	1567480000	SAK Series, Allen hex screw, Screws, Number of poles: 1
GTIN (EAN)	4008190033491	
Qty.	100 pc(s).	

TS 15**Accessories****General ordering data**

Type	TS15X5 ST MPC1217 VER	Version
Order No.	8000037598	Rail, TS 15, Width: 4.13 mm, without slot, Steel, galvanized, chromium-plated
GTIN (EAN)	4050118653106	
Qty.	20 pc(s).	

MPC 12/17/10 7035**Weidmüller Interface GmbH & Co. KG**

Klingenbergstraße 26

D-32758 Detmold

Germany

www.weidmueller.com**Accessories****MPC**

Mounting plates, 1.5 mm sheet steel, galvanised

**General ordering data**

Type	MP MPC 12/17	Version
Order No.	9535560000	MPC (polycarbonate empty enclosure), Mounting plate, Mounting
GTIN (EAN)	4032248009299	plate, Height: 125 mm, Width: 175 mm, Material: Sheet steel,
Qty.	1 pc(s).	galvanized, galvanized

External fixing lugs

External attachment lugs 4-part set

**General ordering data**

Type	MF MPC	Version
Order No.	9535600000	MPC (polycarbonate empty enclosure), Mounting foot, Fixing lugs,
GTIN (EAN)	4032248009381	Height: 30 mm, Width: 15 mm, Depth: 10 mm, Material: Plastic
Qty.	1 pc(s).	

MPC 12/17/10 7035

Weidmüller Interface GmbH & Co. KG

Klingenbergstraße 26

D-32758 Detmold

Germany

www.weidmueller.com

Accessories

Klippon® POK earthing stud



The Klippon® POK enclosure range is made from a high-quality glass fibre reinforced polyester and is ideal for applications and environments where corrosion resistance, impact resistance and a high IP protection class are a requirement.

Key features of the extensive product range:

- Available in 17 sizes
- Two standard finishes (colours): grey (similar to RAL 7001 for industrial use) and black (similar to RAL 9011 for harsh environments, Ex)
- Cover with stainless steel screws in cross-head / slotted design
- Moulded gasket made of silicone or chloroprene
- Fixing holes outside the sealed area to ensure high ingress protection of IP66
- Impact resistance up to 7 Joules
- Mounting directly in the enclosure or using an internal mounting plate
- Direct wall mounting possible using fixing holes or mounting feet
- Fastening thread to attach mounting rails and plates
- Up to E60 fire rating dependent on the configuration
- Weidmüller can manufacture and supply this enclosure to match customer specifications - fitted with all necessary terminals and cable glands.

General ordering data

Type	PEBZ M6 BR SET	Version
Order No.	1277250000	Klippon POK (polyester empty enclosure), Earthing stud,
GTIN (EAN)	4050118067149	Miscellaneous, Height: 12.3 mm, Width: 12.3 mm, Depth: 42 mm,
Qty.	1 pc(s).	Material: Brass
Type	PEBZ M6 S4 SET	Version
Order No.	1283430000	Klippon POK (polyester empty enclosure), Earthing stud,
GTIN (EAN)	4050118073607	Miscellaneous, Height: 12.3 mm, Width: 12.3 mm, Depth: 42 mm,
Qty.	1 pc(s).	Material: Stainless steel 1.4404 (316L)
Type	PEBZ M10 BR SET	Version
Order No.	1277220000	Klippon POK (polyester empty enclosure), Earthing stud,
GTIN (EAN)	4050118067019	Miscellaneous, Height: 21 mm, Width: 21 mm, Depth: 48.7 mm,
Qty.	1 pc(s).	Material: Brass
Type	PEBZ M10 S4 SET	Version
Order No.	1283440000	Klippon POK (polyester empty enclosure), Earthing stud,
GTIN (EAN)	4050118073362	Miscellaneous, Height: 21 mm, Width: 21 mm, Depth: 48.7 mm,
Qty.	1 pc(s).	Material: Stainless steel 1.4404 (316L)

MPC 12/17/10 7035

Weidmüller Interface GmbH & Co. KG

Klingenbergstraße 26

D-32758 Detmold

Germany

www.weidmueller.com

Accessories

Hinge

MPC series, hinges, set of 2



General ordering data

Type	HG MPC	Version
Order No.	9535590000	MPC (polycarbonate empty enclosure), External joint, Hinge, Material:
GTIN (EAN)	4032248009329	Plastic
Qty.	1 pc(s).	

Ventilation plugs - DAE



In addition to cable glands for a wide range of applications, the product portfolio is rounded off by plugs, pressure compensation elements, adaptors and the corresponding accessories such as locknuts, sealing rings, flat washers and earthing rings.

General ordering data

Type	DAE M12 PA LONG	Version
Order No.	1868570000	DAE (ventilation element), Compensating element, straight, M 12, 10
GTIN (EAN)	4032248440429	mm, IP66, IP68, IP69K, Polyamide 6
Qty.	10 pc(s).	
Type	DAE M12 SS	Version
Order No.	1868550000	DAE (ventilation element), Compensating element, straight, M 12, 10
GTIN (EAN)	4032248440405	mm, IP66, IP68, IP69K, Stainless steel 1.4305 (303)
Qty.	10 pc(s).	