

IE-XM-RJ45/RJ45**Weidmüller Interface GmbH & Co. KG**

Klingenbergstraße 26

D-32758 Detmold

Germany

www.weidmueller.com

Mounting rail outlet, RJ45 junction design according to
IEC 60603-7-51

General ordering data

Version	Mounting rail outlet, RJ45, RJ45-RJ45 coupler, IP20, Cat.6A / Class EA (ISO/IEC 11801 2010)
Order No.	8879050000
Type	IE-XM-RJ45/RJ45
GTIN (EAN)	4032248614844
Qty.	1 pc(s).

IE-XM-RJ45/RJ45

Weidmüller Interface GmbH & Co. KG

Klingenbergstraße 26

D-32758 Detmold

Germany

www.weidmueller.com

Technical data

Dimensions and weights

Net weight	49 g
------------	------

Temperatures

Operating temperature	-25 °C...70 °C
-----------------------	----------------

General data

Connection 1	RJ45	Connection 2	RJ45
Description of article		Configuration	1 TE pitch dimension acc. to DIN 43880. insta-compatible Installation flange with mounting frame
Wiring	RJ45-RJ45 coupler Colour-coded pin assignment acc. to EIA/TIA T568 A (copper)	Colour	Light Grey
Housing main material	PA 66, UL 94: V-0	Category	Cat.6A / Class EA (ISO/IEC 11801 2010)
Type of mounting	TS 35	Shielding	360°; shield contact
Protection degree	IP20	Plugging cycles	750

Electrical properties

Contact resistance	≤ 20 mΩ	Current-carrying capacity at 50 °C	1 A
Dielectric strength, contact / contact	≥ 1000 V AC/DC	Dielectric strength, contact / shield	≥ 1500 V AC/DC
Insulation strength	500 MΩ	PoE / PoE+	conforming to IEEE 802.3at

General standards

Certificate No. (DNV)	TAE00003EW	Certificate no. (cULus)	E316369
Connector standard	IEC 60603-7-5		

Classifications

ETIM 6.0	EC001121	ETIM 7.0	EC001121
ETIM 8.0	EC001121	ETIM 9.0	EC001121
ECLASS 9.0	27-44-03-90	ECLASS 9.1	27-44-03-90
ECLASS 10.0	27-44-03-90	ECLASS 11.0	27-44-03-90
ECLASS 12.0	27-44-03-90	ECLASS 13.0	27-44-03-90

Environmental Product Compliance

REACH SVHC	/
------------	---

IE-XM-RJ45/RJ45**Weidmüller Interface GmbH & Co. KG**

Klingenbergstraße 26

D-32758 Detmold

Germany

www.weidmueller.com**Technical data****Approvals**

Approvals



ROHS	Conform
UL File Number Search	UL Website
Certificate no. (cULus)	E316369

Downloads

Approval/Certificate/Document of Conformity	GOST Approval DUXR.E316369 PROFINET Manufacturer's Declaration
Engineering Data	CAD data – STEP
Engineering Data	Zuken E3.S
User Documentation	MAN IE GUIDE DE MAN IE GUIDE EN Manual
Catalogues	Catalogues in PDF-format
Brochures	FL FIELDWIRING EN PI PROFINET CABLING EN PI PROFINET CABLING EN

IE-XM-RJ45/RJ45

Weidmüller Interface GmbH & Co. KG
Klingenbergstraße 26
D-32758 Detmold
Germany

www.weidmueller.com

Drawings

Dimensioned drawing

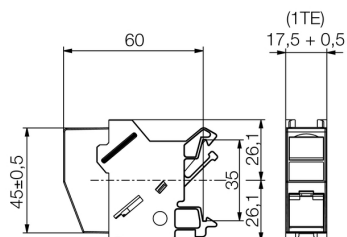

Product image



Product image

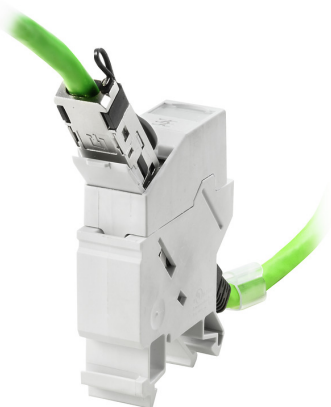

IE-XM-RJ45/RJ45

Weidmüller Interface GmbH & Co. KG
Klingenbergstraße 26
D-32758 Detmold
Germany

www.weidmueller.com

Accessories

Outlet marker



Markers for the labelling panel of terminal rail outlets from Weidmüller.

The benefits for you:

- white
- blank
- on labelling sheet

General ordering data

Type	IE-DM
Order No.	8813500000
GTIN (EAN)	4032248513345
Qty.	50 pc(s).