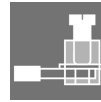
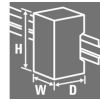

**PAS CMR 2,0...5,0 A DC****Weidmüller Interface GmbH & Co. KG**

Klingenbergstraße 26

D-32758 Detmold

Germany

[www.weidmueller.com](http://www.weidmueller.com)**Product image**

The PLUGCONTROL PAS CMRs present a simple, cost-effective solution for monitoring DC currents up to 10 A.

The monitoring relay (REED contact) comes attached to a standard base so that it can be mounted on a TS35 DIN rail.

Current monitoring of valves, servo-controls and DC motors are typical applications for these modules.

**General ordering data**

Version	Current monitoring, 2...5.0 A DC, 1, Screw connection
Order No.	<a href="#">8742620000</a>
Type	PAS CMR 2,0...5,0 A DC
GTIN (EAN)	4032248413935
Qty.	10 pc(s).

## PAS CMR 2,0...5,0 A DC

Weidmüller Interface GmbH &amp; Co. KG

Klingenbergstraße 26

D-32758 Detmold

Germany

www.weidmueller.com

## Technical data

## Dimensions and weights

Depth	95 mm	Depth (inches)	3.74 inch
Height	16 mm	Height (inches)	0.63 inch
Width	15.3 mm	Width (inches)	0.602 inch
Length	92 mm	Length (inches)	3.622 inch
Net weight	60.9 g		

## Temperatures

Storage temperature	-40 °C...85 °C	Operating temperature	-20 °C...60 °C
Humidity at operating temperature		Humidity	5-95% relative humidity, T <sub>u</sub> = 40°C, without condensation
	0...95 % (no condensation)		

## Probability of failure

SIL in compliance with IEC 61508	None
----------------------------------	------

## General data

Configuration	none	Galvanic isolation	2-way isolator, between input/output/supply
Protection degree	IP20	Rail	TS 35
Temperature coefficient	350 ppm/K		

## Insulation coordination

EMC standards	EN 55011, EN 61000-6-1, 2, 3, 4	Galvanic isolation	2-way isolator, between input/output/supply
Impulse withstand voltage	6 kV	Insulation voltage	4 kV <sub>eff</sub> / 1 min.
Pollution severity	2	Rated voltage	300 V
Surge voltage category	III		

## Input

Input current	2...5.0 A DC	Input resistance, current	<50 mΩ
Making current threshold	≤ 2 A	Max. current	15 A for 10 s
Pulse duration	min. 1 ms	Resistance of sensor circuit	50 Ω
Secure off	≤ 300 mA		

## Output

Contact assembly	1 NO contact	Contact material	RH/Rd (Reed contact)*
Continuous current	100 mA	Max. switching frequency	20 Hz
Max. switching voltage, AC	250 V	Max. switching voltage, DC	100 V
Number of outputs	1	Switching current	100 mA
Switching voltage AC, min.	1 V	Switching voltage DC, min.	1 V
Temperature coefficient	350 ppm/K		

## Connection data

Type of connection	Screw connection	Clamping range, rated connection	1.5 mm <sup>2</sup>
Clamping range, min.	2.5 mm <sup>2</sup>	Clamping range, max.	2.5 mm <sup>2</sup>

**PAS CMR 2,0...5,0 A DC****Weidmüller Interface GmbH & Co. KG**

Klingenbergstraße 26

D-32758 Detmold

Germany

[www.weidmueller.com](http://www.weidmueller.com)**Technical data****Classifications**

ETIM 6.0	EC002654	ETIM 7.0	EC002654
ETIM 8.0	EC002654	ETIM 9.0	EC002654
ECLASS 9.0	27-21-01-22	ECLASS 9.1	27-21-01-22
ECLASS 10.0	27-21-01-22	ECLASS 11.0	27-21-01-22
ECLASS 12.0	27-21-01-22	ECLASS 13.0	27-21-01-22
ECLASS 14.0	27-21-01-22		

## PAS CMR 2,0...5,0 A DC

**Weidmüller Interface GmbH & Co. KG**  
 Klingenbergstraße 26  
 D-32758 Detmold  
 Germany

www.weidmueller.com

## Technical data

## Tender specification sheets

## Long specification

**Limit-value monitoring  
 of DC currents up to 5 A  
 with switching output**

limit-value monitoring component for measuring DC currents 2...5 A with switching output. The monitoring unit is designed so that it can be plugged onto the mounting base.

**Pluggable unit on base,  
 for mounting on TS35**

**DIN rail**

**Dimensions: L/W/H 92/  
 15.3/ 95 mm**

**Screw connection /  
 Nominal cross-section**

**2.5 mm<sup>2</sup>**

**Protection degree: IP  
 20**

Input **2 ...5**

**A DC / Reed relay coil**

**Switch-on threshold  
 < 2 A**

**Switch-off threshold  
 < 300 mA**

**Output**

**1 NO / Reed contact**

**Switching current max**

**100 mA AC/DC**

**Switching voltage 100**

**V AC / 50 V DC**

**Ambient**

**temperature range 0**

**°C...+55 °C**

**Secure isolation**

**EN 50178,**

**2-way isolation up to 6**

**kV**

**Test voltage**

**4**

**kVeff / 1 min. input**

**against output**

**Rated**

**voltage**

**300 V AC/DC at**

**overvoltage category III**

**and pollution degree 2**

**Approvals cULus**

**Type**

**PAS CMR 2.0...5.0 A**

**DC**

## Short specification

**Limit-value monitoring  
 of DC currents up to 5 A  
 with switching output**

limit-value monitoring component for measuring DC currents 2...5 A with switching output. The monitoring unit is designed so that it can be plugged onto the mounting base.

**PAS CMR 2,0...5,0 A DC**

**Weidmüller Interface GmbH & Co. KG**  
Klingenbergstraße 26  
D-32758 Detmold  
Germany

[www.weidmueller.com](http://www.weidmueller.com)

**Technical data****Environmental Product Compliance**

RoHS Compliance Status	Compliant
REACH SVHC	No SVHC above 0.1 wt%

**Approvals**

Approvals



ROHS	Conform
UL File Number Search	UL Website
Certificate no. (cULus)	E141197

**Downloads**

Approval/Certificate/Document of Conformity	<a href="#">Application notes – Declaration of Conformity</a>
User Documentation	<a href="#">Instruction sheet</a>
Catalogues	<a href="#">Catalogues in PDF-format</a>
Brochures	

## PAS CMR 2,0...5,0 A DC

**Weidmüller Interface GmbH & Co. KG**  
Klingenbergstraße 26  
D-32758 Detmold  
Germany

[www.weidmueller.com](http://www.weidmueller.com)

# Drawings

## Electric symbol

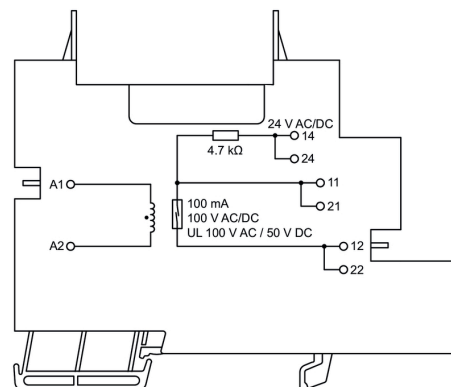
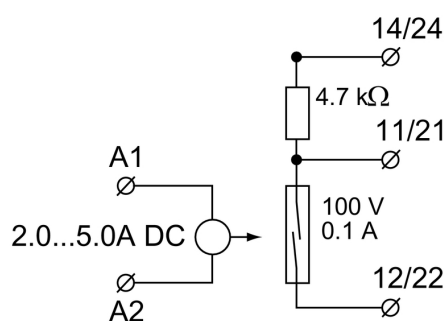

**PAS CMR 2,0...5,0 A DC****Weidmüller Interface GmbH & Co. KG**

Klingenbergstraße 26

D-32758 Detmold

Germany

[www.weidmueller.com](http://www.weidmueller.com)**Accessories****PLUGSERIES****General ordering data**

Type	ZQV 2.5N 1/4-2 SW	Version
Order No.	<a href="#">1784270000</a>	PLUGSERIES, Cross-connector
GTIN (EAN)	4032248214679	
Qty.	60 pc(s).	
Type	ZQV 2.5N 1/4-2 RT	Version
Order No.	<a href="#">1784280000</a>	PLUGSERIES, Cross-connector
GTIN (EAN)	4032248214686	
Qty.	60 pc(s).	
Type	PRC HALTEBUEGEL	Version
Order No.	<a href="#">8536700000</a>	PLUGSERIES, Retaining clip
GTIN (EAN)	4032248171965	
Qty.	100 pc(s).	
Type	ZQV 2.5N 1/4-2 BL	Version
Order No.	<a href="#">1784290000</a>	PLUGSERIES, Cross-connector
GTIN (EAN)	4032248216383	
Qty.	60 pc(s).	

## PAS CMR 2,0...5,0 A DC

Weidmüller Interface GmbH &amp; Co. KG

Klingenbergstraße 26

D-32758 Detmold

Germany

www.weidmueller.com

## Accessories

## Blank



WS markers are the perfect match for the W-series connectors. Thanks to their system compatibility, the WS tags can also be used with the I-series and the Z-series. The large marking surfaces do not only permit long character strings but also multi-line text. WS markers are ideal for labels with long, customised character strings. Thanks to the proven MultiCard format, printing with PrintJet CONNECT oder/or Plotter is possible.

- Can be fitted in strips or individually
- Markers in proven MultiCard format

**For custom printing:** Please send us a file of our labeling software M-Print PRO or M-Print PRO Online (without installation) for your labeling specifications.

## General ordering data

Type	WS 10/5 MC NE WS	Version
Order No.	<a href="#">1635000000</a>	WS, Terminal marker, 10 x 5 mm, Pitch in mm (P): 5.00 Weidmueller,
GTIN (EAN)	4008190261948	Allen-Bradley, white
Qty.	720 pc(s).	

## Blank



WS markers are the perfect match for the W-series connectors. Thanks to their system compatibility, the WS tags can also be used with the I-series and the Z-series. The large marking surfaces do not only permit long character strings but also multi-line text. WS markers are ideal for labels with long, customised character strings. Thanks to the proven MultiCard format, printing with PrintJet CONNECT oder/or Plotter is possible.

- Can be fitted in strips or individually
- Markers in proven MultiCard format

**For custom printing:** Please send us a file of our labeling software M-Print PRO or M-Print PRO Online (without installation) for your labeling specifications.

## General ordering data

Type	WS 15/5 MC NE WS	Version
Order No.	<a href="#">1609880000</a>	WS, Terminal marker, 15 x 5 mm, Pitch in mm (P): 5.00 Weidmueller,
GTIN (EAN)	4008190203504	Allen-Bradley, white
Qty.	480 pc(s).	