

IE-PS-M12X-180-S-TH-CG**Weidmüller Interface GmbH & Co. KG**

Klingenbergstraße 26

D-32758 Detmold

Germany

www.weidmueller.com

The 8pole M12 Mini crimp cable connector with X-coding and 90° cable exit is with compact dimensions and 8 cable exit positions predestined for difficult installation conditions. The cable clamp version with the wide cable clamp ranges from 4 up to 9 mm plus the fully shielded housing together with the shielded strain relief is the universal fail-safe solution for all common cables on the market.

General ordering data

Order No.	2672440000
Type	IE-PS-M12X-180-S-TH-CG
GTIN (EAN)	4050118765045
Qty.	1 pc(s).

IE-PS-M12X-180-S-TH-CG**Weidmüller Interface GmbH & Co. KG**

Klingenbergstraße 26

D-32758 Detmold

Germany

www.weidmueller.com

Technical data**Dimensions and weights**

Net weight	16 g
------------	------

Technical data customisable plug-in connectors

Cable diameter	4...9 mm	Cable diameter, max.	9 mm
Cable diameter, min.	4 mm	Coding	X-coded
Conductor cross-section, max.	0.34 mm ²	Conductor cross-section, min.	0.14 mm ²
Connection cross-section, max.	0.34 mm ²	Connection cross-section, min.	0.14 mm ²
Contact surface	Gold-plated	Housing main material	Cu alloy Ni plated
Number of poles	8	Plugging cycles	≥ 500
Pollution severity	3	Protection degree	IP67 plugged
Rated current	4 A	Rated voltage	50 V
Shield connection	Yes, screwed	Temperature range of housing	-40 ... +85 °C
Type of connection	Crimp connection		

General Info

Number of poles	8	Connection 1	M12
Connection 2	Crimp	Housing main material	Cu alloy Ni plated
Connection thread	M12	Contact surface	Gold-plated
Protection degree	IP67 plugged	Plugging cycles	≥ 500

Electrical properties

Rated voltage	50 V
---------------	------

General standards

Connector standard	IEC 61076-2-109
--------------------	-----------------

Standards

Connector standard	IEC 61076-2-109
--------------------	-----------------

Classifications

ETIM 6.0	EC002635	ETIM 7.0	EC002635
ETIM 8.0	EC002635	ETIM 9.0	EC002635
ECLASS 9.0	27-44-01-02	ECLASS 9.1	27-44-01-03
ECLASS 10.0	27-44-01-02	ECLASS 11.0	27-44-01-02
ECLASS 12.0	27-44-01-16	ECLASS 13.0	27-44-01-02

Environmental Product Compliance

REACH SVHC	Lead 7439-92-1
SCIP	67cf1078-beca-4687-860b-dc475a6ec24a

Approvals

ROHS	Conform
------	---------

IE-PS-M12X-180-S-TH-CG

Weidmüller Interface GmbH & Co. KG

Klingenbergstraße 26

D-32758 Detmold

Germany

www.weidmueller.com

Technical data

Downloads

Engineering Data

[CAD data – STEP](#)

Catalogues

[Catalogues in PDF-format](#)

IE-PS-M12X-180-S-TH-CG

Weidmüller Interface GmbH & Co. KG
Klingenbergstraße 26
D-32758 Detmold
Germany

www.weidmueller.com

Drawings

Dimensioned drawing

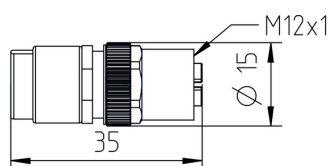

Dimensioned drawing

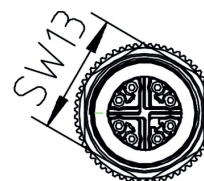

Pole scheme

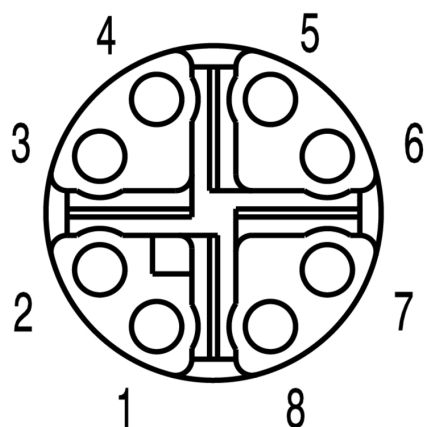

IE-PS-M12X-180-S-TH-CG**Weidmüller Interface GmbH & Co. KG**

Klingenbergstraße 26

D-32758 Detmold

Germany

www.weidmueller.com**Accessories****...for M12**

Weidmüller offers a wide range of tools and accessories for sensor-actuator cabling.

General ordering data

Type	SAI-TMCSK	Version
Order No.	1381690000	Pressing tool, 4-indent crimp
GTIN (EAN)	4050118183870	
Qty.	1 pc(s).	

M12X crimp contacts

Machined precision crimp contacts for M12X

**General ordering data**

Type	IE-PIC-M12X-S-22/26	Version
Order No.	2673440000	Contact, Socket connector
GTIN (EAN)	4050118765359	
Qty.	100 pc(s).	