

CMA-31-500-5A-5VA-1**Weidmüller Interface GmbH & Co. KG**

Klingenbergstraße 26

D-32758 Detmold

Germany

www.weidmueller.com

**Plug-on current transformers**

Plug-on current transformers are especially suitable for mounting on the busbar.

The advantages of this type are: Price optimisation, safe connection option, high mechanical holding forces and high current resistance.

General ordering data

Version	Primary current: 500 A, Secondary current max.: 5 A, Load: 5 VA, Tolerance class: 1, closed current transformer
Order No.	2420910000
Type	CMA-31-500-5A-5VA-1
GTIN (EAN)	4050118429169
Qty.	1 pc(s).
Manufacturer	MBS AG

CMA-31-500-5A-5VA-1

Weidmüller Interface GmbH & Co. KG

Klingenbergstraße 26

D-32758 Detmold

Germany

www.weidmueller.com

Technical data

Dimensions and weights

Depth	52 mm	Depth (inches)	2.047 inch
Height	80.9 mm	Height (inches)	3.185 inch
Width	60 mm	Width (inches)	2.362 inch
Net weight	270 g		

Temperatures

Storage temperature	-25 °C...70 °C	Operating temperature	-5 °C...50 °C
---------------------	----------------	-----------------------	---------------

Dimensions of live conductors

Type of conductor	Insulated conductor only	Round conductor	25.7 mm
Rail	20 x 20 mm, 25 x 12 mm, 30 x 10 mm	Installation location	Indoor use

Electrical attributes

Load	5 VA	Primary current	500 A
Secondary current	0...5 A	Tolerance class	1

Technical properties

Insulation class	E	Nominal frequency	50 Hz
Thermal rated continuous current I_{thermal}	$1.2 \times I_{\text{rated}}$		

Insulation coordination

Standard	IEC 61869-1: 2007, IEC 61869-2: 2012	Tolerance class	1
----------	---	-----------------	---

Classifications

ETIM 6.0	EC002048	ETIM 7.0	EC002048
ETIM 8.0	EC002048	ETIM 9.0	EC002048
ECLASS 9.0	27-21-09-02	ECLASS 9.1	27-21-09-02
ECLASS 10.0	27-21-09-02	ECLASS 11.0	27-21-09-02
ECLASS 12.0	27-21-09-02	ECLASS 13.0	27-21-09-02
ECLASS 14.0	27-21-09-02		

Environmental Product Compliance

REACH SVHC	/
RoHS Compliance Status	Compliant

Approvals

ROHS	Conform
------	---------

CMA-31-500-5A-5VA-1

Weidmüller Interface GmbH & Co. KG
Klingenbergstraße 26
D-32758 Detmold
Germany

www.weidmueller.com

Technical data

Downloads

Approval/Certificate/Document of Conformity	UL- certificate UKCA Declaration of Conformity Declaration of Conformity
Engineering Data	CAD data – STEP
User Documentation	Device description – instruction sheet english.pdf Device description – Betriebsanleitung deutsch
Catalogues	Catalogues in PDF-format

CMA-31-500-5A-5VA-1

Weidmüller Interface GmbH & Co. KG
Klingenbergstraße 26
D-32758 Detmold
Germany

www.weidmueller.com

Drawings

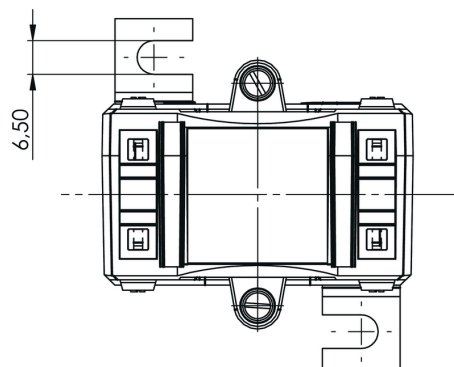
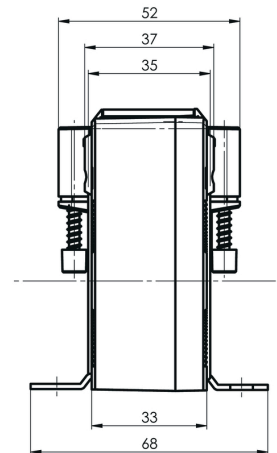
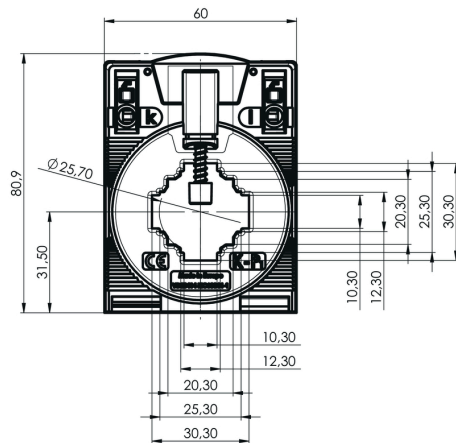

CMA-31-500-5A-5VA-1

Weidmüller Interface GmbH & Co. KG

Klingenbergstraße 26

D-32758 Detmold

Germany

www.weidmueller.com

Accessories

Plug-on current transformer - ValueLine



Plug-on current transformers

Plug-on current transformers are especially suitable for mounting on the busbar.

The advantages of this type are: Price optimisation, safe connection option, high mechanical holding forces and high current resistance.

General ordering data

Type	CMA-31-41-SNAP-ON
Order No.	2723380000
GTIN (EAN)	4050118810622
Qty.	1 pc(s).