

HDC 06B DODL 2BO**Weidmüller Interface GmbH & Co. KG**

Klingenbergstraße 26

D-32758 Detmold

Germany

www.weidmueller.com

The special die-cast alloy and the multi-layered surface sealing provide complete protection for the HDC housings.

The cleverly designed interlock system is manufactured from stainless steel. This guarantees a long lifespan with high resistance to corrosion and impact.

The housing interlock system provides integrated safety. Our unique, patented spring system provides the housing interlock with a secure grip and prevents accidental opening.

The laser marking allows for easy and quick identification. Each housing is permanently labelled with a laser marking so that each product can be quickly designated and positioned.

Weidmüller RockStar® IP 65 / NEMA Type 4X housings - your first choice for industrial housings with IP 65 protection.

General ordering data

Version	HDC enclosures, Size: 3, Protection degree: IP65 (in plugged condition), Cover for lower part of housing, End-locking clamp, lower side, Standard
Order No.	1665200000
Type	HDC 06B DODL 2BO
GTIN (EAN)	4008190421908
Qty.	1 pc(s).

HDC 06B DODL 2BO

Weidmüller Interface GmbH & Co. KG

Klingenbergstraße 26

D-32758 Detmold

Germany

www.weidmueller.com

Technical data

Dimensions and weights

Height	18 mm	Height (inches)	0.709 inch
Width	43 mm	Width (inches)	1.693 inch
Net weight	58 g		

Temperatures

Limit temperature	-40 °C ... 125 °C
-------------------	-------------------

Dimensions

Cable entry	For bases	Height of housing B	18 mm
Total length housing	60 mm	Width housing C	43 mm

General data

EMC housings	No	Housing main material	diecast aluminium
Material of locking element		Protection degree	IP65 (in plugged condition)
Surface finish	Stainless steel, rust-proof	Tightening torque	1.2 Nm
	Powder coating		

Version

BG	3	Cable entry	For bases
Clamp version	End-locking clamp	Colour (RAL)	RAL 7035
Design		Design of housing	Cover for lower part of housing
	Standard		
Design of locking system	End-locking clamp, lower side	Size	3
Suitable for ModuPlug®	Yes	Tightening torque	1.2 Nm
Top part/bottom part/lid	Cover	Type	Cover

Classifications

ETIM 6.0	EC000437	ETIM 7.0	EC000437
ETIM 8.0	EC000437	ETIM 9.0	EC000437
ECLASS 9.0	27-44-02-02	ECLASS 9.1	27-44-02-02
ECLASS 10.0	27-44-02-02	ECLASS 11.0	27-44-02-02
ECLASS 12.0	27-44-02-02	ECLASS 13.0	27-44-02-02

Substance	Acetone
Chemical resistance	Conditionally resistant
Substance	Drilling oil
Chemical resistance	Resistant
Substance	Diesel
Chemical resistance	Resistant
Substance	Ethyl alcohol
Chemical resistance	Resistant
Substance	Transmission oil
Chemical resistance	Resistant
Substance	Hydraulic oil

HDC 06B DODL 2BO

Weidmüller Interface GmbH & Co. KG

Klingenbergstraße 26

D-32758 Detmold

Germany

www.weidmueller.com

Technical data

Chemical resistance	Resistant
Substance	Coolant
Chemical resistance	Resistant
Substance	Petroleum benzine
Chemical resistance	Resistant
Substance	Sweat
Chemical resistance	Resistant
Substance	Premium gasoline
Chemical resistance	Conditionally resistant
Substance	Water
Chemical resistance	Resistant
Substance	UV
Chemical resistance	Unstable
Substance	Ozone
Chemical resistance	Unstable

Environmental Product Compliance

REACH SVHC	Lead 7439-92-1
SCIP	d447edfa-0214-4f34-b5ba-82eae491b46a
Chemical resistance	de.myview.objectmodel.impl.BlockImpl@2d5c99c0 de.myview.objectmodel.impl.BlockImpl@34cde0c9 de.myview.objectmodel.impl.BlockImpl@76c0bfe7 de.myview.objectmodel.impl.BlockImpl@5f534244 de.myview.objectmodel.impl.BlockImpl@160842f7 de.myview.objectmodel.impl.BlockImpl@4d983357 de.myview.objectmodel.impl.BlockImpl@3e549284 de.myview.objectmodel.impl.BlockImpl@7bd0b668 de.myview.objectmodel.impl.BlockImpl@2f1b4c1f de.myview.objectmodel.impl.BlockImpl@2315c020 de.myview.objectmodel.impl.BlockImpl@394fb674 de.myview.objectmodel.impl.BlockImpl@475234c3 de.myview.objectmodel.impl.BlockImpl@32dce382

Approvals

Approvals



ROHS	Conform
UL File Number Search	UL Website
Certificate No. (cURus)	E92202

Downloads

Approval/Certificate/Document of Conformity	Manufacturer's declaration
Engineering Data	CAD data – STEP
Product Change Notification	20220214 Technical change to HDC housings 20220214 Technische Änderung bei HDC-Gehäusen
Technical Documentation	1665200000_HDC_06B_DODL_2BO_STP_Blatt_1.pdf
Catalogues	Catalogues in PDF-format
Brochures	FL FIELDWIRING EN FL FIELDWIRING EN

HDC 06B DODL 2B0

Weidmüller Interface GmbH & Co. KG
Klingenbergstraße 26
D-32758 Detmold
Germany

www.weidmueller.com

Drawings

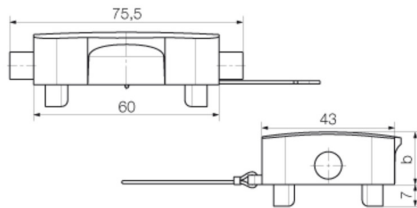

HDC 06B DODL 2BO

Weidmüller Interface GmbH & Co. KG

Klingenbergstraße 26

D-32758 Detmold

Germany

www.weidmueller.com

Accessories

Bulkhead housing



The special die-cast alloy and the multi-layered surface sealing provide complete protection for the HDC housings.

The cleverly designed interlock system is manufactured from stainless steel. This guarantees a long lifespan with high resistance to corrosion and impact.

The housing interlock system provides integrated safety. Our unique, patented spring system provides the housing interlock with a secure grip and prevents accidental opening.

The laser marking allows for easy and quick identification. Each housing is permanently labelled with a laser marking so that each product can be quickly designated and positioned.

Weidmüller RockStar® IP 65 / NEMA Type 4X housings - your first choice for industrial housings with IP 65 protection.

General ordering data

Type	HDC 06B ALU	Version
Order No.	1202100000	HDC enclosures, Size: 3, Protection degree: IP65 (in plugged condition), Bulkhead housing, End-locking clamp, lower side, End-
GTIN (EAN)	4008190149369	locking clamp not replaceable, Standard
Qty.	1 pc(s).	

Coupling hood



The special die-cast alloy and the multi-layered surface sealing provide complete protection for the HDC housings.

The cleverly designed interlock system is manufactured from stainless steel. This guarantees a long lifespan with high resistance to corrosion and impact.

The housing interlock system provides integrated safety. Our unique, patented spring system provides the housing interlock with a secure grip and prevents accidental opening.

The laser marking allows for easy and quick identification. Each housing is permanently labelled with a laser marking so that each product can be quickly designated and positioned.

Weidmüller RockStar® IP 65 / NEMA Type 4X housings - your first choice for industrial housings with IP 65 protection.

General ordering data

Type	HDC 06B KLU 1M25G	Version
Order No.	1021330000	HDC enclosures, Size: 3, Protection degree: IP65 (in plugged condition), Coupling housing, End-locking clamp, lower side, Standard,
GTIN (EAN)	4032248734948	Size of cable entries: PG 16
Qty.	1 pc(s).	
Type	HDC 06B KLU 1PG16G	Version
Order No.	1653200000	HDC enclosures, Size: 3, Protection degree: IP65 (in plugged condition), Coupling housing, End-locking clamp, lower side, Standard,
GTIN (EAN)	4008190403270	Size of cable entries: PG 16
Qty.	1 pc(s).	

HDC 06B DODL 2B0

Weidmüller Interface GmbH & Co. KG

Klingenbergstraße 26

D-32758 Detmold

Germany

www.weidmueller.com

Accessories

Type	HDC 16D KLU 1PG21G	Version
Order No.	1653230000	HDC enclosures, Size: 3, Protection degree: IP65 (in plugged
GTIN (EAN)	4008190403300	condition), Coupling housing, End-locking clamp, lower side, high, Size
Qty.	1 pc(s).	of cable entries: PG 21

Base housing



The special die-cast alloy and the multi-layered surface sealing provide complete protection for the HDC housings.

The cleverly designed interlock system is manufactured from stainless steel. This guarantees a long lifespan with high resistance to corrosion and impact.

The housing interlock system provides integrated safety. Our unique, patented spring system provides the housing interlock with a secure grip and prevents accidental opening.

The laser marking allows for easy and quick identification. Each housing is permanently labelled with a laser marking so that each product can be quickly designated and positioned.

Weidmüller RockStar® IP 65 / NEMA Type 4X housings - your first choice for industrial housings with IP 65 protection.

General ordering data

Type	HDC 06B SLU 2M20G N	Version
Order No.	2560850000	HDC enclosures, Size: 3, Protection degree: IP65 (in plugged
GTIN (EAN)	4050118673081	condition), Base housing, End-locking clamp, lower side, , without
Qty.	1 pc(s).	cover, Size of cable entries: M 20
Type	HDC 16D SLU 2M32G	Version
Order No.	1787510000	HDC enclosures, Size: 3, Protection degree: IP65 (in plugged
GTIN (EAN)	4032248204854	condition), Base housing, End-locking clamp, lower side, high, without
Qty.	1 pc(s).	cover, Size of cable entries: M 32
Type	HDC 06B SLU 1M20G	Version
Order No.	1900460000	HDC enclosures, Size: 3, Protection degree: IP65 (in plugged
GTIN (EAN)	4032248585939	condition), Base housing, End-locking clamp, lower side, Standard,
Qty.	1 pc(s).	without cover, Size of cable entries: M 20
Type	HDC 06B SLU 2M20G	Version
Order No.	1788140000	HDC enclosures, Size: 3, Protection degree: IP65 (in plugged
GTIN (EAN)	4032248205585	condition), Base housing, End-locking clamp, lower side, Standard,
Qty.	1 pc(s).	without cover, Size of cable entries: M 20
Type	HDC 06B SLU 2PG16G	Version
Order No.	1652760000	HDC enclosures, Size: 3, Protection degree: IP65 (in plugged
GTIN (EAN)	4008190402839	condition), Base housing, End-locking clamp, lower side, Standard,
Qty.	1 pc(s).	without cover, Size of cable entries: PG 16
Type	HDC 16D SLU 2PG21G	Version
Order No.	1652840000	HDC enclosures, Size: 3, Protection degree: IP65 (in plugged
GTIN (EAN)	4008190402914	condition), Base housing, End-locking clamp, lower side, high, without
Qty.	1 pc(s).	cover, Size of cable entries: PG 21
Type	HDC 06B SLU 2M25G N	Version
Order No.	2560860000	HDC enclosures, Size: 3, Protection degree: IP65 (in plugged
GTIN (EAN)	4050118673098	condition), Base housing, End-locking clamp, lower side, , without
Qty.	1 pc(s).	cover, Size of cable entries: M 25

Creation date July 7, 2024 8:21:53 PM CEST

HDC 06B DODL 2B0

Weidmüller Interface GmbH & Co. KG

Klingenbergstraße 26

D-32758 Detmold

Germany

www.weidmueller.com

Accessories

Type	HDC 06B SLU 1PG16G	Version
Order No.	1652750000	HDC enclosures, Size: 3, Protection degree: IP65 (in plugged condition), Base housing, End-locking clamp, lower side, Standard, without cover, Size of cable entries: PG 16
GTIN (EAN)	4008190402822	
Qty.	1 pc(s).	
Type	HDC 06B SLU 1M25G N	Version
Order No.	2560710000	HDC enclosures, Size: 3, Protection degree: IP65 (in plugged condition), Base housing, End-locking clamp, lower side, , without cover, Size of cable entries: M 25
GTIN (EAN)	4050118673272	
Qty.	1 pc(s).	
Type	HDC 06B SLU 1PG16G N	Version
Order No.	2560840000	HDC enclosures, Size: 3, Protection degree: IP65 (in plugged condition), Base housing, End-locking clamp, lower side, , without cover, Size of cable entries: PG 16
GTIN (EAN)	4050118673074	
Qty.	1 pc(s).	
Type	HDC 16D SLU 2M25G	Version
Order No.	1787520000	HDC enclosures, Size: 3, Protection degree: IP65 (in plugged condition), Base housing, End-locking clamp, lower side, high, without cover, Size of cable entries: M 25
GTIN (EAN)	4032248204861	
Qty.	1 pc(s).	
Type	HDC 16D SLU 1M32G	Version
Order No.	1900900000	HDC enclosures, Size: 3, Protection degree: IP65 (in plugged condition), Base housing, End-locking clamp, lower side, high, without cover, Size of cable entries: M 32
GTIN (EAN)	4032248521128	
Qty.	1 pc(s).	
Type	HDC 16D SLU 1M25G	Version
Order No.	1900880000	HDC enclosures, Size: 3, Protection degree: IP65 (in plugged condition), Base housing, End-locking clamp, lower side, high, without cover, Size of cable entries: M 25
GTIN (EAN)	4032248521111	
Qty.	1 pc(s).	
Type	HDC 06B SLU 1M25G	Version
Order No.	1900480000	HDC enclosures, Size: 3, Protection degree: IP65 (in plugged condition), Base housing, End-locking clamp, lower side, Standard, without cover, Size of cable entries: M 25
GTIN (EAN)	4032248585946	
Qty.	1 pc(s).	
Type	HDC 06B SLU 2M25G	Version
Order No.	1788130000	HDC enclosures, Size: 3, Protection degree: IP65 (in plugged condition), Base housing, End-locking clamp, lower side, Standard, without cover, Size of cable entries: M 25
GTIN (EAN)	4032248205578	
Qty.	1 pc(s).	