

**HDC 10A KLU 1PG16G****Weidmüller Interface GmbH & Co. KG**

Klingenbergstraße 26

D-32758 Detmold

Germany

[www.weidmueller.com](http://www.weidmueller.com)**IP65**

The special die-cast alloy and the multi-layered surface sealing provide complete protection for the HDC housings.

The cleverly designed interlock system is manufactured from stainless steel. This guarantees a long lifespan with high resistance to corrosion and impact.

The housing interlock system provides integrated safety. Our unique, patented spring system provides the housing interlock with a secure grip and prevents accidental opening.

The laser marking allows for easy and quick identification. Each housing is permanently labelled with a laser marking so that each product can be quickly designated and positioned.

Weidmüller RockStar® IP 65 / NEMA Type 4X housings - your first choice for industrial housings with IP 65 protection.

**General ordering data**

|            |  |
|------------|--|
| Version    | HDC enclosures, Size: 2, Protection degree: IP65 (in plugged condition), Coupling housing, End-locking clamp, lower side, Standard, Size of cable entries: PG 16 |
| Order No.  | <a href="#">1664560000</a>   |
| Type       | HDC 10A KLU 1PG16G   |
| GTIN (EAN) | 4008190421250  |
| Qty.       | 1 pc(s).   |

## HDC 10A KLU 1PG16G

Weidmüller Interface GmbH &amp; Co. KG

Klingenbergstraße 26

D-32758 Detmold

Germany

www.weidmueller.com

## Technical data

## Dimensions and weights

|            |         |                 |            |
|------------|---------|-----------------|------------|
| Height     | 48 mm   | Height (inches) | 1.89 inch  |
| Width      | 53.5 mm | Width (inches)  | 2.106 inch |
| Net weight | 129 g   |                 |            |

## Temperatures

|                   |                   |
|-------------------|-------------------|
| Limit temperature | -40 °C ... 125 °C |
|-------------------|-------------------|

## Dimensions

|                      |           |                     |         |
|----------------------|-----------|---------------------|---------|
| Cable entry          | w. thread | Height of housing B | 48 mm   |
| Total length housing | 63 mm     | Width housing C     | 29.5 mm |

## General data

|                             |                             |                       |                             |
|-----------------------------|-----------------------------|-----------------------|-----------------------------|
| EMC housings                | No                          | Housing main material | diecast aluminium           |
| Material of locking element |                             | Protection degree     | IP65 (in plugged condition) |
| Surface finish              | Stainless steel, rust-proof | Tightening torque     | 0.5 Nm                      |
|                             | Powder coating              |                       |                             |

## Version

|                              |                               |                                |                    |
|------------------------------|-------------------------------|--------------------------------|--------------------|
| BG                           | 2                             | Cable entry                    | w. thread          |
| Clamp version                | End-locking clamp             | Colour (RAL)                   | RAL 7035           |
| Design                       | Standard                      | Design of housing              | Coupling housing   |
| Design of locking system     | End-locking clamp, lower side | Internal thread                | PG 16              |
| Number of cable entry on top | 1                             | Number of cable entry sideways | 0                  |
| Size                         | 2                             | Size of cable entries          | PG 16              |
| Suitable for ModuPlug®       | No                            | Tightening torque              | 0.5 Nm             |
| Top part/bottom part/lid     | lower part                    | Type                           | coupling extension |

## Classifications

|             |             |             |             |
|-------------|-------------|-------------|-------------|
| ETIM 6.0    | EC000437    | ETIM 7.0    | EC000437    |
| ETIM 8.0    | EC000437    | ETIM 9.0    | EC000437    |
| ECLASS 9.0  | 27-44-02-02 | ECLASS 9.1  | 27-44-02-02 |
| ECLASS 10.0 | 27-44-02-02 | ECLASS 11.0 | 27-44-02-02 |
| ECLASS 12.0 | 27-44-02-02 | ECLASS 13.0 | 27-44-02-02 |
| ECLASS 14.0 | 27-44-02-02 |             |             |

|                     |                         |
|---------------------|-------------------------|
| Substance           | Acetone                 |
| Chemical resistance | Conditionally resistant |
| Substance           | Drilling oil            |
| Chemical resistance | Resistant               |
| Substance           | Diesel                  |
| Chemical resistance | Resistant               |
| Substance           | Ethyl alcohol           |
| Chemical resistance | Resistant               |
| Substance           | Transmission oil        |
| Chemical resistance | Resistant               |

Creation date October 2, 2024 5:51:53 PM CEST

**HDC 10A KLU 1PG16G****Weidmüller Interface GmbH & Co. KG**

Klingenbergstraße 26

D-32758 Detmold

Germany

[www.weidmueller.com](http://www.weidmueller.com)**Technical data**

|                     |                         |
|---------------------|-------------------------|
| Substance           | Hydraulic oil           |
| Chemical resistance | Resistant               |
| Substance           | Coolant                 |
| Chemical resistance | Resistant               |
| Substance           | Petroleum benzine       |
| Chemical resistance | Resistant               |
| Substance           | Sweat                   |
| Chemical resistance | Resistant               |
| Substance           | Premium gasoline        |
| Chemical resistance | Conditionally resistant |
| Substance           | Water                   |
| Chemical resistance | Resistant               |
| Substance           | UV                      |
| Chemical resistance | Unstable                |
| Substance           | Ozone                   |
| Chemical resistance | Unstable                |

**Environmental Product Compliance**

|                                      |  |
|--------------------------------------|--|
| REACH SVHC                           | Lead 7439-92-1 Potassium perfluorobutane sulfonate 29420-49-3  |
| SCIP                                 | e98b2b24-ba23-41bf-8d19-Odda3647412f   |
| Chemical resistance                  | de.myview.objectmodel.impl.BlockImpl@6878bd63 de.myview.objectmodel.impl.BlockImpl@6cc6024c de.myview.objectmodel.impl.BlockImpl@45084c68 de.myview.objectmodel.impl.BlockImpl@779f8404 de.myview.objectmodel.impl.BlockImpl@5aa1bc31 de.myview.objectmodel.impl.BlockImpl@6a9114b de.myview.objectmodel.impl.BlockImpl@1c576fa de.myview.objectmodel.impl.BlockImpl@af16d62 de.myview.objectmodel.impl.BlockImpl@5d660839 de.myview.objectmodel.impl.BlockImpl@130b6997 de.myview.objectmodel.impl.BlockImpl@3953bfaa de.myview.objectmodel.impl.BlockImpl@38c85f9f de.myview.objectmodel.impl.BlockImpl@5582bf7f |
| RoHS Compliance Status               | Compliant with exemption   |
| RoHS Exemption (if applicable/known) | 6bl  |

**Approvals**

Approvals



|                         |            |
|-------------------------|------------|
| ROHS                    | Conform    |
| UL File Number Search   | UL Website |
| Certificate No. (cURus) | E92202     |

## HDC 10A KLU 1PG16G

**Weidmüller Interface GmbH & Co. KG**  
Klingenbergstraße 26  
D-32758 Detmold  
Germany

[www.weidmueller.com](http://www.weidmueller.com)

## Technical data

### Downloads

Approval/Certificate/Document of Con-  
formity

[Manufacturer's declaration](#)

Engineering Data

[CAD data – STEP](#)

Product Change Notification

[20220214 Technical change to HDC housings](#)

[20220214 Technische Änderung bei HDC-Gehäusen](#)

Technical Documentation

[1664560000 HDC 10A KLU 1PG16G STP Blatt 1.pdf](#)

Catalogues

[Catalogues in PDF-format](#)

Brochures

[FL FIELDWIRING EN](#)

[FL FIELDWIRING EN](#)

## HDC 10A KLU 1PG16G

**Weidmüller Interface GmbH & Co. KG**  
Klingenbergstraße 26  
D-32758 Detmold  
Germany

[www.weidmueller.com](http://www.weidmueller.com)

# Drawings

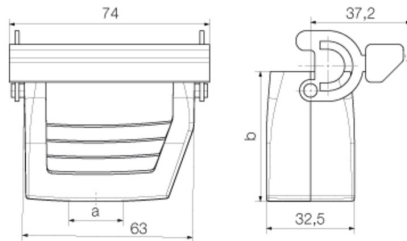

**HDC 10A KLU 1PG16G****Weidmüller Interface GmbH & Co. KG**

Klingenbergstraße 26

D-32758 Detmold

Germany

[www.weidmueller.com](http://www.weidmueller.com)**Accessories****Cover**

The special die-cast alloy and the multi-layered surface sealing provide complete protection for the HDC housings.

The cleverly designed interlock system is manufactured from stainless steel. This guarantees a long lifespan with high resistance to corrosion and impact.

The housing interlock system provides integrated safety. Our unique, patented spring system provides the housing interlock with a secure grip and prevents accidental opening.

The laser marking allows for easy and quick identification. Each housing is permanently labelled with a laser marking so that each product can be quickly designated and positioned.

Weidmüller RockStar® IP 65 / NEMA Type 4X housings - your first choice for industrial housings with IP 65 protection.

**General ordering data**

|            |                            |   |
|------------|----------------------------|---|
| Type       | HDC 10A DMDL 2B0           | Version   |
| Order No.  | <a href="#">1665880000</a> | HDC enclosures, Size: 2, Protection degree: IP65 (in plugged condition), Cover for lower part of housing, End-locking clamp, lower side, Standard |
| GTIN (EAN) | 4008190422912              |   |
| Qty.       | 1 pc(s).                   |   |