

HDC 40D SBU 2PG21G**Weidmüller Interface GmbH & Co. KG**

Klingenbergstraße 26

D-32758 Detmold

Germany

www.weidmueller.com**IP65**

The special die-cast alloy and the multi-layered surface sealing provide complete protection for the HDC housings.

The cleverly designed interlock system is manufactured from stainless steel. This guarantees a long lifespan with high resistance to corrosion and impact.

The housing interlock system provides integrated safety. Our unique, patented spring system provides the housing interlock with a secure grip and prevents accidental opening.

The laser marking allows for easy and quick identification. Each housing is permanently labelled with a laser marking so that each product can be quickly designated and positioned.

Weidmüller RockStar® IP 65 / NEMA Type 4X housings - your first choice for industrial housings with IP 65 protection.

General ordering data

Version	HDC enclosures, Size: 6, Protection degree: IP65 (in plugged condition), Base housing, Side-locking clamp on lower side, high, Size of cable entries: PG 21
Order No.	1656810000
Type	HDC 40D SBU 2PG21G
GTIN (EAN)	4008190409821
Qty.	1 pc(s).

HDC 40D SBU 2PG21G**Weidmüller Interface GmbH & Co. KG**

Klingenbergstraße 26

D-32758 Detmold

Germany

www.weidmueller.com

Technical data**Dimensions and weights**

Height	84 mm	Height (inches)	3.307 inch
Width	56.5 mm	Width (inches)	2.224 inch
Mounting dimension - height	45 mm	Mounting dimension - width	105 mm
Net weight	459 g		

Temperatures

Limit temperature	-40 °C ... 125 °C
-------------------	-------------------

Dimensions

Cable entry	w. thread	Height of base B1	5 mm
Height of housing B	84 mm	Hole pitch length A2	105 mm
Total length housing	93.3 mm	Width base C1	56.5 mm
Width housing C	43 mm		

General data

EMC housings	No	Housing main material	diecast aluminium
Material of locking element	Stainless steel, rust-proof	Protection degree	IP65 (in plugged condition)
Surface finish	Powder coating		

Version

BG	6	Cable entry	w. thread
Clamp version	Side-locking clamp	Colour (RAL)	RAL 7035
Design	high	Design of housing	Base housing
Design of locking system	Side-locking clamp on lower side	Internal thread	PG 21
Number of cable entry on top	0	Number of cable entry sideways	2
Sealing	NBR	Size	6
Size of cable entries	PG 21	Suitable for ModuPlug®	Yes
Top part/bottom part/lid	lower part	Type	Base housing

Classifications

ETIM 6.0	EC000437	ETIM 7.0	EC000437
ETIM 8.0	EC000437	ETIM 9.0	EC000437
ECLASS 9.0	27-44-02-02	ECLASS 9.1	27-44-02-02
ECLASS 10.0	27-44-02-02	ECLASS 11.0	27-44-02-02
ECLASS 12.0	27-44-02-02	ECLASS 13.0	27-44-02-02
ECLASS 14.0	27-44-02-02		

Substance	Acetone
Chemical resistance	Conditionally resistant
Substance	Drilling oil
Chemical resistance	Resistant
Substance	Diesel
Chemical resistance	Resistant
Substance	Ethyl alcohol
Chemical resistance	Resistant

Creation date October 6, 2024 1:32:20 AM CEST

HDC 40D SBU 2PG21G**Weidmüller Interface GmbH & Co. KG**

Klingenbergstraße 26

D-32758 Detmold

Germany

www.weidmueller.com**Technical data**

Substance	Transmission oil
Chemical resistance	Resistant
Substance	Hydraulic oil
Chemical resistance	Resistant
Substance	Coolant
Chemical resistance	Resistant
Substance	Petroleum benzine
Chemical resistance	Resistant
Substance	Sweat
Chemical resistance	Resistant
Substance	Premium gasoline
Chemical resistance	Conditionally resistant
Substance	Water
Chemical resistance	Resistant
Substance	UV
Chemical resistance	Unstable
Substance	Ozone
Chemical resistance	Unstable

Environmental Product Compliance

REACH SVHC	Lead 7439-92-1 Potassium perfluorobutane sulfonate 29420-49-3
SCIP	e98b2b24-ba23-41bf-8d19-Odda3647412f
Chemical resistance	de.myview.objectmodel.impl.BlockImpl@545ade6e de.myview.objectmodel.impl.BlockImpl@b7e8bd2 de.myview.objectmodel.impl.BlockImpl@2cf5db11 de.myview.objectmodel.impl.BlockImpl@1e0c539e de.myview.objectmodel.impl.BlockImpl@1c27579f de.myview.objectmodel.impl.BlockImpl@63787fd2 de.myview.objectmodel.impl.BlockImpl@61571dff de.myview.objectmodel.impl.BlockImpl@1dbb32e8 de.myview.objectmodel.impl.BlockImpl@3b86156f de.myview.objectmodel.impl.BlockImpl@1b207b22 de.myview.objectmodel.impl.BlockImpl@42c1255c de.myview.objectmodel.impl.BlockImpl@6a9739e de.myview.objectmodel.impl.BlockImpl@d8f3349
RoHS Compliance Status	Compliant with exemption
RoHS Exemption (if applicable/known)	6bl

Approvals

Approvals



ROHS	Conform
UL File Number Search	UL Website
Certificate No. (cURus)	E92202

HDC 40D SBU 2PG21G

Weidmüller Interface GmbH & Co. KG

Klingenbergstraße 26

D-32758 Detmold

Germany

www.weidmueller.com

Technical data

Downloads

Approval/Certificate/Document of Conformity

[Manufacturer's declaration](#)

Engineering Data

[CAD data – STEP](#)

Product Change Notification

[20220214 Technical change to HDC housings](#)

[20220214 Technische Änderung bei HDC-Gehäusen](#)

Technical Documentation

[1656810000 HDC_40D_SBU_2PG21G_STP_Blatt_1.pdf](#)

Catalogues

[Catalogues in PDF-format](#)

Brochures

[FL FIELDWIRING EN](#)

[FL FIELDWIRING EN](#)

HDC 40D SBU 2PG21G

Weidmüller Interface GmbH & Co. KG
Klingenbergstraße 26
D-32758 Detmold
Germany

www.weidmueller.com

Drawings

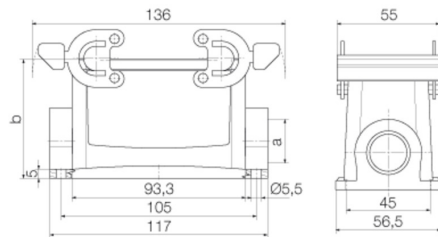

HDC 40D SBU 2PG21G

Weidmüller Interface GmbH & Co. KG
 Klingenbergstraße 26
 D-32758 Detmold
 Germany

www.weidmueller.com

Accessories

Hood, Cable Entry sideways



The special die-cast alloy and the multi-layered surface sealing provide complete protection for the HDC housings.

The cleverly designed interlock system is manufactured from stainless steel. This guarantees a long lifespan with high resistance to corrosion and impact.

The housing interlock system provides integrated safety. Our unique, patented spring system provides the housing interlock with a secure grip and prevents accidental opening.

The laser marking allows for easy and quick identification. Each housing is permanently labelled with a laser marking so that each product can be quickly designated and positioned.

Weidmüller RockStar® IP 65 / NEMA Type 4X housings - your first choice for industrial housings with IP 65 protection.

General ordering data

Type	HDC 40D TSBU 1M32G	Version
Order No.	1787000000	HDC enclosures, Size: 6, Protection degree: IP65 (in plugged condition), Cable entry from side, Plug housing, Side-locking clamp on lower side, high, Size of cable entries: M 32
GTIN (EAN)	4032248204243	
Qty.	1 pc(s).	
Type	HDC 40D TSBU 1PG21G	Version
Order No.	1656520000	HDC enclosures, Size: 6, Protection degree: IP65 (in plugged condition), Cable entry from side, Plug housing, Side-locking clamp on lower side, high, Size of cable entries: PG 21
GTIN (EAN)	4008190409531	
Qty.	1 pc(s).	
Type	HDC 16B TSBU 1M40G	Version
Order No.	1809620000	HDC enclosures, Size: 6, Protection degree: IP65 (in plugged condition), Cable entry from side, Plug housing, Side-locking clamp on lower side, Standard, Size of cable entries: M 40
GTIN (EAN)	4032248284979	
Qty.	1 pc(s).	
Type	HDC 40D TSBU 1M40G	Version
Order No.	1904800000	HDC enclosures, Size: 6, Protection degree: IP65 (in plugged condition), Cable entry from side, Plug housing, Side-locking clamp on lower side, high, Size of cable entries: M 40
GTIN (EAN)	4032248521852	
Qty.	1 pc(s).	
Type	HDC 16B TSBU 1PG21G	Version
Order No.	1656480000	HDC enclosures, Size: 6, Protection degree: IP65 (in plugged condition), Cable entry from side, Plug housing, Side-locking clamp on lower side, Standard, Size of cable entries: PG 21
GTIN (EAN)	4008190409494	
Qty.	1 pc(s).	
Type	HDC 40D TSBU 1M25G	Version
Order No.	1787010000	HDC enclosures, Size: 6, Protection degree: IP65 (in plugged condition), Cable entry from side, Plug housing, Side-locking clamp on lower side, high, Size of cable entries: M 25
GTIN (EAN)	4032248204250	
Qty.	1 pc(s).	
Type	HDC 16B TSBU 1M25G	Version
Order No.	1788180000	HDC enclosures, Size: 6, Protection degree: IP65 (in plugged condition), Cable entry from side, Plug housing, Side-locking clamp on lower side, Standard, Size of cable entries: M 25
GTIN (EAN)	4032248205714	
Qty.	1 pc(s).	
Type	HDC 40D TSBU 1PG29G	Version
Order No.	1656540000	HDC enclosures, Size: 6, Protection degree: IP65 (in plugged condition), Cable entry from side, Plug housing, Side-locking clamp on lower side, high, Size of cable entries: PG 29
GTIN (EAN)	4008190409555	
Qty.	1 pc(s).	

HDC 40D SBU 2PG21G

Weidmüller Interface GmbH & Co. KG
 Klingenbergstraße 26
 D-32758 Detmold
 Germany

www.weidmueller.com

Accessories

Hood, Cable Entry at top



The special die-cast alloy and the multi-layered surface sealing provide complete protection for the HDC housings.

The cleverly designed interlock system is manufactured from stainless steel. This guarantees a long lifespan with high resistance to corrosion and impact.

The housing interlock system provides integrated safety. Our unique, patented spring system provides the housing interlock with a secure grip and prevents accidental opening.

The laser marking allows for easy and quick identification. Each housing is permanently labelled with a laser marking so that each product can be quickly designated and positioned.

Weidmüller RockStar® IP 65 / NEMA Type 4X housings - your first choice for industrial housings with IP 65 protection.

General ordering data

Type	HDC 16B TOBU 1PG21G	Version
Order No.	1656590000	HDC enclosures, Size: 6, Protection degree: IP65 (in plugged condition), Cable entry from top, Plug housing, Side-locking clamp on lower side, Standard, Size of cable entries: PG 21
GTIN (EAN)	4008190409609	
Qty.	1 pc(s).	
Type	HDC 40D TOBU 2M25	Version
Order No.	1208380000	HDC enclosures, Size: 6, Protection degree: IP65, IP65 (in plugged condition), Cable entry from top, Plug housing, Side-locking clamp on lower side, high, Size of cable entries: M 25
GTIN (EAN)	4032248100248	
Qty.	1 pc(s).	
Type	HDC 16B TOBU 1M25G	Version
Order No.	1788210000	HDC enclosures, Size: 6, Protection degree: IP65 (in plugged condition), Cable entry from top, Plug housing, Side-locking clamp on lower side, Standard, Size of cable entries: M 25
GTIN (EAN)	4032248205745	
Qty.	1 pc(s).	
Type	HDC 40D TOBU 1PG29G	Version
Order No.	1656650000	HDC enclosures, Size: 6, Protection degree: IP65 (in plugged condition), Cable entry from top, Plug housing, Side-locking clamp on lower side, high, Size of cable entries: PG 29
GTIN (EAN)	4008190409661	
Qty.	1 pc(s).	
Type	HDC 40D TOBU 1M25G	Version
Order No.	1787070000	HDC enclosures, Size: 6, Protection degree: IP65 (in plugged condition), Cable entry from top, Plug housing, Side-locking clamp on lower side, high, Size of cable entries: M 25
GTIN (EAN)	4032248204410	
Qty.	1 pc(s).	
Type	HDC 40D TOBU 1PG21G	Version
Order No.	1656630000	HDC enclosures, Size: 6, Protection degree: IP65 (in plugged condition), Cable entry from top, Plug housing, Side-locking clamp on lower side, high, Size of cable entries: PG 21
GTIN (EAN)	4008190409647	
Qty.	1 pc(s).	
Type	HDC 40D TOBU 1M32G	Version
Order No.	1787060000	HDC enclosures, Size: 6, Protection degree: IP65 (in plugged condition), Cable entry from top, Plug housing, Side-locking clamp on lower side, high, Size of cable entries: M 32
GTIN (EAN)	4032248204304	
Qty.	1 pc(s).	

HDC 40D SBU 2PG21G**Weidmüller Interface GmbH & Co. KG**

Klingenbergstraße 26

D-32758 Detmold

Germany

www.weidmueller.com**Accessories****Cover**

The special die-cast alloy and the multi-layered surface sealing provide complete protection for the HDC housings.

The cleverly designed interlock system is manufactured from stainless steel. This guarantees a long lifespan with high resistance to corrosion and impact.

The housing interlock system provides integrated safety. Our unique, patented spring system provides the housing interlock with a secure grip and prevents accidental opening.

The laser marking allows for easy and quick identification. Each housing is permanently labelled with a laser marking so that each product can be quickly designated and positioned.

Weidmüller RockStar® IP 65 / NEMA Type 4X housings - your first choice for industrial housings with IP 65 protection.

General ordering data

Type	HDC 16B DODQ 4B0	Version
Order No.	1665260000	HDC enclosures, Size: 6, Protection degree: IP65 (in plugged condition), Cover for lower part of housing, Side-locking clamp on lower side, Standard
GTIN (EAN)	4008190421960	
Qty.	1 pc(s).	