

IE-CL240W-PP-BASE**Weidmüller Interface GmbH & Co. KG**

Klingenbergstraße 26

D-32758 Detmold

Germany

www.weidmueller.com

Contactless and maintenance-free energy transmission up to 240 W – FreeCon Contactless offers top performance with the smallest dimensions and maximum efficiency.

General ordering data

Version	Contactless power transmission, Primary side
Order No.	1547440000
Type	IE-CL240W-PP-BASE
GTIN (EAN)	4050118352887
Qty.	1 pc(s).

IE-CL240W-PP-BASE

Weidmüller Interface GmbH & Co. KG

Klingenbergstraße 26

D-32758 Detmold

Germany

www.weidmueller.com

Technical data

Dimensions and weights

Height	50 mm	Height (inches)	1.969 inch
Width	100	Width (inches)	3.937 inch
Length	100 mm	Length (inches)	3.937 inch
Net weight	1.236 g		

Temperatures

Operating temperature	-20 °C...45	Note: room temperature (service)	Consider derating
-----------------------	-------------	----------------------------------	-------------------

General data

Air gap	0...5 mm	Centre offset	max. 5mm
Housing main material	Diecast zinc, painted, Cover PBT	Loads	Inductive and resistive loads
Power interface	PROFINET PushPull Power	Protection degree	IP65
Technologie, version	Inductive resonance coupling	Turn-on time	1 s
Weight	1,020 g		

Electrical properties

Degree of efficiency	max. 91 %	LED indicator	Status indication via multi-coloured LED
Primary voltage	24 V DC (21.6...26.4 V DC)		

Classifications

ETIM 6.0	EC002714	ETIM 7.0	EC002714
ETIM 8.0	EC002714	ETIM 9.0	EC002714
ECLASS 9.0	27-27-01-01	ECLASS 9.1	27-27-01-01
ECLASS 10.0	27-27-01-01	ECLASS 11.0	27-27-01-01
ECLASS 12.0	27-27-40-01	ECLASS 13.0	27-27-40-01
ECLASS 14.0	27-27-40-01		

Environmental Product Compliance

RoHS Compliance Status	Compliant without exemption
REACH SVHC	No SVHC above 0.1 wt%

Approvals

Approvals



ROHS	Conform
------	---------

IE-CL240W-PP-BASE

Weidmüller Interface GmbH & Co. KG
Klingenbergstraße 26
D-32758 Detmold
Germany

www.weidmueller.com

Technical data

Downloads

Approval/Certificate/Document of Conformity	EMV / EMC Test CE_FreeCon_Contactless.pdf
Engineering Data	CAD data – STEP
User Documentation	Manual EN MAN IE GUIDE DE MAN IE GUIDE EN Short Manual Manual DE
White paper	Whitepaper FreeCon Contactless Whitepaper FreeCon Contactless
Catalogues	Catalogues in PDF-format
Brochures	MB FREECONCONTACT EN FL FIELDWIRING EN PI PROFINET CABLING EN PI PROFINET CABLING EN

IE-CL240W-PP-BASE

Weidmüller Interface GmbH & Co. KG
Klingenbergstraße 26
D-32758 Detmold
Germany

www.weidmueller.com

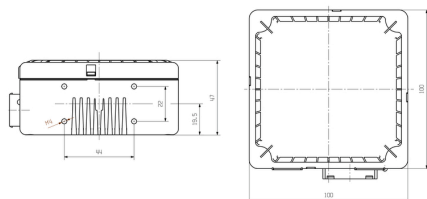
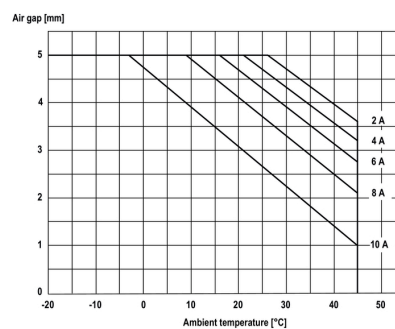
Drawings**Dimensioned drawing****Derating curve**

IE-CL240W-PP-BASE**Weidmüller Interface GmbH & Co. KG**

Klingenbergstraße 26

D-32758 Detmold

Germany

www.weidmueller.com**Accessories****Blank**

ESG is the tried-and-tested marker in MultiCard format for use on many well-known electrical devices. The result is high-quality device marking with a high-contrast appearance.

Various types are available for devices from manufacturers like Siemens, ABB, Beckhoff etc.

Advantages at a glance:

- Tags for universal usage, self-adhesive or clip-on tags, depending on type
- For aligned equipment, e.g. circuit breakers, we supply ESG markers for clipping onto tag rails
- Individual laser-quality printing according to specifications

For custom printing: Please send us a file of our labeling software M-Print PRO or M-Print PRO Online (without installation) for your labeling specifications.

General ordering data

Type	ESG 6/17 K MC NE WS	Version
Order No.	1880120000	ESG, Device markers x 17 mm, PA 66, Colour: white, Self-adhesive
GTIN (EAN)	4032248478804	
Qty.	200 pc(s).	

Sets

PushPull Power plug-in connector according to PROFINET specification

General ordering data

Type	IE-PS-VAPM-24V	Version
Order No.	1068910000	Power connector, Plug, PROFINET, Set of connectors
GTIN (EAN)	4032248823079	
Qty.	10 pc(s).	

IE-CL240W-PP-BASE

Weidmüller Interface GmbH & Co. KG

Klingenbergstraße 26

D-32758 Detmold

Germany

www.weidmueller.com

Accessories

UPS control unit



The UPS control unit together with the associated battery module and the power supply unit form a complete DC UPS system. In normal operation, the input voltage from the UPS control unit is connected directly to the load. In the event of a mains failure (drop of the DC input voltage) the system switches instantly to battery operation. Once the mains supply has been restored, the system switches back to normal operation and the battery is fully recharged by the integrated charger.

Three relay outputs, as well as three additional active transistor outputs and a control input to lock battery operation, provide full remote control by means of SPS or DCS control. Numerous modes of operation and an easy-to-use status display provide rapid fault diagnosis and optimum customisation to the application.

General ordering data

Type	CP DC UPS 24V 20A/10A	Version
Order No.	1370050010	UPS control unit
GTIN (EAN)	4050118202335	
Qty.	1 pc(s).	

Battery module



The 5 battery modules with capacities from 1,2 Ah to 17Ah can supply up to 40 A for 30 minutes or 1 A for 30 hours and are fully compatible with the DC UPS control units CP DC UPS 24V 20A/10A & CP DC UPS 24V 40A. And for sure, the DURAeco series is a flexible & ease of use solution in a cost-effective design.

General ordering data

Type	CP A BATTERY 24V DC17AH	Version
Order No.	1251110000	Battery
GTIN (EAN)	4050118043136	
Qty.	1 pc(s).	