

**HDC 32B ADLU****Weidmüller Interface GmbH & Co. KG**

Klingenbergstraße 26

D-32758 Detmold

Germany

[www.weidmueller.com](http://www.weidmueller.com)**IP65**

The special die-cast alloy and the multi-layered surface sealing provide complete protection for the HDC housings.

The cleverly designed interlock system is manufactured from stainless steel. This guarantees a long lifespan with high resistance to corrosion and impact.

The housing interlock system provides integrated safety. Our unique, patented spring system provides the housing interlock with a secure grip and prevents accidental opening.

The laser marking allows for easy and quick identification. Each housing is permanently labelled with a laser marking so that each product can be quickly designated and positioned.

Weidmüller RockStar® IP 65 / NEMA Type 4X housings - your first choice for industrial housings with IP 65 protection.

**General ordering data**

Version	HDC enclosures, Size: 10, Protection degree: IP65 (in plugged condition), Bulkhead housing, End-locking clamp, lower side, Standard, with cover
Order No.	<a href="#">1219800000</a>
Type	HDC 32B ADLU
GTIN (EAN)	4008190111090
Qty.	1 pc(s).

## HDC 32B ADLU

Weidmüller Interface GmbH &amp; Co. KG

Klingenbergstraße 26

D-32758 Detmold

Germany

www.weidmueller.com

## Technical data

## Dimensions and weights

Depth	127 mm	Depth (inches)	5 inch
Height	55 mm	Height (inches)	2.165 inch
Width	143 mm	Width (inches)	5.63 inch
Mounting dimension - height	65 mm	Mounting dimension - width	110 mm
Net weight	394 g		

## Temperatures

Limit temperature	-40 °C ... 125 °C
-------------------	-------------------

## Dimensions

Height of base B1	7 mm	Height of housing B	55 mm
Hole pitch length A2	110 mm	Total length housing	94 mm
Width base C1	89 mm	Width housing C	83 mm

## General data

EMC housings	No	Housing main material	diecast aluminium
Material of locking element	Stainless steel, rust-proof	Protection class note	Protection class with secured cover: IP 65
Protection degree	IP65 (in plugged condition)	Surface finish	Powder coating
Tightening torque	2 Nm		

## Version

BG	10	Clamp version	End-locking clamp
Colour (RAL)	RAL 7035	Cover	with cover
Design	Standard	Design of cover	with cover
Design of housing	Bulkhead housing	Design of locking system	End-locking clamp, lower side
Sealing	NBR	Size	10
Suitable for ModuPlug®	Yes	Tightening torque	2 Nm
Top part/bottom part/lid	lower part	Type	Bulkhead (feed-through)

## Classifications

ETIM 6.0	EC000437	ETIM 7.0	EC000437
ETIM 8.0	EC000437	ETIM 9.0	EC000437
ECLASS 9.0	27-44-02-02	ECLASS 9.1	27-44-02-02
ECLASS 10.0	27-44-02-02	ECLASS 11.0	27-44-02-02
ECLASS 12.0	27-44-02-02	ECLASS 13.0	27-44-02-02

Substance	Acetone
Chemical resistance	Conditionally resistant
Substance	Drilling oil
Chemical resistance	Resistant
Substance	Diesel
Chemical resistance	Resistant
Substance	Ethyl alcohol
Chemical resistance	Resistant

## HDC 32B ADLU

Weidmüller Interface GmbH &amp; Co. KG

Klingenbergstraße 26

D-32758 Detmold

Germany

www.weidmueller.com

## Technical data

Substance	Transmission oil
Chemical resistance	Resistant
Substance	Hydraulic oil
Chemical resistance	Resistant
Substance	Coolant
Chemical resistance	Resistant
Substance	Petroleum benzine
Chemical resistance	Resistant
Substance	Sweat
Chemical resistance	Resistant
Substance	Premium gasoline
Chemical resistance	Conditionally resistant
Substance	Water
Chemical resistance	Resistant
Substance	UV
Chemical resistance	Unstable
Substance	Ozone
Chemical resistance	Unstable

## Environmental Product Compliance

REACH SVHC	Lead 7439-92-1 Potassium perfluorobutane sulfonate 29420-49-3
SCIP	e98b2b24-ba23-41bf-8d19-0dda3647412f
Chemical resistance	de.myview.objectmodel.impl.BlockImpl@6569eb50 de.myview.objectmodel.impl.BlockImpl@22cd6ce5 de.myview.objectmodel.impl.BlockImpl@6a6c12e6 de.myview.objectmodel.impl.BlockImpl@1b16eab7 de.myview.objectmodel.impl.BlockImpl@318fa1ee de.myview.objectmodel.impl.BlockImpl@78ec497e de.myview.objectmodel.impl.BlockImpl@729d8fa7 de.myview.objectmodel.impl.BlockImpl@5ef29011 de.myview.objectmodel.impl.BlockImpl@123ecaf0 de.myview.objectmodel.impl.BlockImpl@803d670 de.myview.objectmodel.impl.BlockImpl@167d9060 de.myview.objectmodel.impl.BlockImpl@5cc5f8a6 de.myview.objectmodel.impl.BlockImpl@3848c084

## Important note

Product information	When mounting the housings, make sure that the flat gasket is correctly seated.
---------------------	---

## Approvals

Approvals



ROHS	Conform
UL File Number Search	UL Website
Certificate No. (cURus)	E92202

## HDC 32B ADLU

**Weidmüller Interface GmbH & Co. KG**

Klingenbergstraße 26

D-32758 Detmold

Germany

[www.weidmueller.com](http://www.weidmueller.com)

## Technical data

### Downloads

Approval/Certificate/Document of Con-  
formity

[Manufacturer's declaration](#)

Engineering Data

[CAD data – STEP](#)

Product Change Notification

[20220214 Technical change to HDC housings](#)

[20220214 Technische Änderung bei HDC-Gehäusen](#)

Technical Documentation

[1219800000 HDC\\_32B\\_ADLU\\_STP\\_Blatt\\_\\_1.pdf](#)

Catalogues

[Catalogues in PDF-format](#)

Brochures

[FL FIELDWIRING EN](#)

[FL FIELDWIRING EN](#)

## HDC 32B ADLU

**Weidmüller Interface GmbH & Co. KG**  
Klingenbergstraße 26  
D-32758 Detmold  
Germany

[www.weidmueller.com](http://www.weidmueller.com)

## Drawings

### Dimensioned drawing

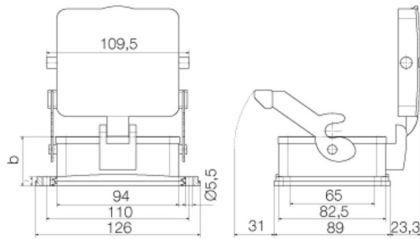

## HDC 32B ADLU

Weidmüller Interface GmbH &amp; Co. KG

Klingenbergstraße 26

D-32758 Detmold

Germany

www.weidmueller.com

## Accessories

## Housing, cable entry sideways



The special die-cast alloy and the multi-layered surface sealing provide complete protection for the HDC housings.

The cleverly designed interlock system is manufactured from stainless steel. This guarantees a long lifespan with high resistance to corrosion and impact.

The housing interlock system provides integrated safety. Our unique, patented spring system provides the housing interlock with a secure grip and prevents accidental opening.

The laser marking allows for easy and quick identification. Each housing is permanently labelled with a laser marking so that each product can be quickly designated and positioned.

Weidmüller RockStar® IP 65 / NEMA Type 4X housings - your first choice for industrial housings with IP 65 protection.

## General ordering data

Type	HDC 32B TSLU 1M32G	Version
Order No.	<a href="#">1788420000</a>	HDC enclosures, Size: 10, Protection degree: IP65 (in plugged condition), Cable entry from side, Plug housing, End-locking clamp,
GTIN (EAN)	4032248205950	lower side, Standard, Size of cable entries: M 32
Qty.	1 pc(s).	
Type	HDC 32B TSLU 1PG29G	Version
Order No.	<a href="#">1667120000</a>	HDC enclosures, Size: 10, Protection degree: IP65 (in plugged condition), Cable entry from side, Plug housing, End-locking clamp,
GTIN (EAN)	4008190424329	lower side, Standard, Size of cable entries: PG 29
Qty.	1 pc(s).	

## Housing, cable entry at top



The special die-cast alloy and the multi-layered surface sealing provide complete protection for the HDC housings.

The cleverly designed interlock system is manufactured from stainless steel. This guarantees a long lifespan with high resistance to corrosion and impact.

The housing interlock system provides integrated safety. Our unique, patented spring system provides the housing interlock with a secure grip and prevents accidental opening.

The laser marking allows for easy and quick identification. Each housing is permanently labelled with a laser marking so that each product can be quickly designated and positioned.

Weidmüller RockStar® IP 65 / NEMA Type 4X housings - your first choice for industrial housings with IP 65 protection.

## General ordering data

Type	HDC 32B TOLU 1M32G	Version
Order No.	<a href="#">1788450000</a>	HDC enclosures, Size: 10, Protection degree: IP65 (in plugged condition), Cable entry from top, Plug housing, End-locking clamp,
GTIN (EAN)	4032248205981	lower side, Standard, Size of cable entries: M 32
Qty.	1 pc(s).	

**HDC 32B ADLU****Weidmüller Interface GmbH & Co. KG**

Klingenbergstraße 26

D-32758 Detmold

Germany

[www.weidmueller.com](http://www.weidmueller.com)**Accessories**

Type	HDC 32B TOLU 1PG29G	Version
Order No.	<a href="#">1219300000</a>	HDC enclosures, Size: 10, Protection degree: IP65 (in plugged
GTIN (EAN)	4008190164652	condition), Cable entry from top, Plug housing, End-locking clamp,
Qty.	1 pc(s).	lower side, Standard, Size of cable entries: PG 29