

IE-C6FP8LM0200M40M40-M**Weidmüller Interface GmbH & Co. KG**

Klingenbergstraße 26

D-32758 Detmold

Germany

www.weidmueller.com

Assembled IE cables, patch cable Cabinet Line, Cat. 6,
LSZH, magenta

General ordering data

Version	Patch cable, RJ45 IP 20, RJ45 IP 20, <20 m: Cat.6A / >20 m Class EA (ISO/IEC 11801 2010), LSZH, 20 m
Order No.	1201270200
Type	IE-C6FP8LM0200M40M40-M
GTIN (EAN)	4032248984558
Qty.	1 pc(s).

IE-C6FP8LM0200M40M40-M

Weidmüller Interface GmbH & Co. KG

Klingenbergstraße 26

D-32758 Detmold

Germany

www.weidmueller.com

Technical data

Dimensions and weights

Length	20 m	Length (inches)	787.402 inch
Net weight	753 g		

Temperatures

Storage temperature	-20 °C...60 °C	Operating temperature	-20 °C...60 °C
Installation temperature	0 °C...50 °C		

Electrical properties

Current-carrying capacity at 50 °C	1 A	PoE / PoE+	conforming to IEEE 802.3at
------------------------------------	-----	------------	----------------------------

General standards

Application-specific communication cable facilities	ANSI / TIA / EIA-568-B.2-10, ISO / IEC 11801:2002, EN50173-1:2007	Certificate no. (cULus)	E316369
Connector standard	IEC 60603-7-51		

Standards

Connector standard	IEC 60603-7-51
--------------------	----------------

Cable structure

Arrangement of wire cores	Twisted pair	Colour sequence or wires - wire pairs	white - blue, white - orange, white - green, white - brown
Complete shielding	Shielding braid made from copper wiring	Cross-section	4*2*AWG 27/7 - 4*2*0.1 mm ²
Insulation	PE	Insulation cross-section	1.04 mm
Material sheath	LSZH	Number of wires	8
Overlap of shielding braid	60 %	Sheath diameter, max.	5.9 mm
Sheath diameter, min.	5.5 mm	Sheathing colour	Magenta
Shielding	S/FTP	Strands	7
Wire pair shielding	Aluminium foil		

Electrical properties of cable

Capacity at 1 kHz	46 nF/km	Category	<20 m: Cat.6A / >20 m Class EA (ISO/IEC 11801 2010)
Characteristic impedance	100 ± 15 Ω at 1–100 MHz	Coupling attenuation up to 1000 MHz	80 dB
Coupling resistance at 10 MHz / m	5 mΩ	Delay skew	2.5 ns/100m
Operating voltage	50 V DC	Operating voltage (UL rating)	30 V AC / 42.4 V DC
Resistance differential	5 %	Separating class according to EN 50174-2	d
Test voltage: wire-wire-shield	2.5 kV / DC for 2 sec	Transmission rate	10 Gbit/s

IE-C6FP8LM0200M40M40-M

Weidmüller Interface GmbH & Co. KG

Klingenbergstraße 26

D-32758 Detmold

Germany

www.weidmueller.com

Technical data

Mechanical and material properties of cable

Colour	Magenta	Halogen	halogen-free, according to IEC 60754-2
Min. bending radius, once only		Resistance to spread of flame	in accordance with IEC 60332-2-2, in accordance with IEC 60332-1-2, in accordance with IEC 60332-3-24, in accordance with UL 2556 (FT1)
	4 x cable diameter		

Plug

Plug left	RJ45, IP20, male contact, straight, plug, Plastic, shielded	Plug right	RJ45, IP20, male contact, straight, plug, Plastic, shielded
-----------	---	------------	---

Plug, left

Plug left	RJ45, IP20, male contact, straight, plug, Plastic, shielded
-----------	---

Plug, right

Plug right	RJ45, IP20, male contact, straight, plug, Plastic, shielded
------------	---

Classifications

ETIM 6.0	EC002599	ETIM 7.0	EC002599
ETIM 8.0	EC002599	ETIM 9.0	EC002599
ECLASS 9.0	27-06-03-08	ECLASS 9.1	27-06-03-08
ECLASS 10.0	27-06-03-08	ECLASS 11.0	27-06-03-08
ECLASS 12.0	27-06-03-08	ECLASS 13.0	27-06-03-08

Environmental Product Compliance

REACH SVHC	/
------------	---

Approvals

Approvals



ROHS	Conform
UL File Number Search	UL Website
Certificate no. (cULus)	E316369

IE-C6FP8LM0200M40M40-M**Weidmüller Interface GmbH & Co. KG**

Klingenbergstraße 26

D-32758 Detmold

Germany

www.weidmueller.com**Technical data****Downloads**

Approval/Certificate/Document of Conformity	DUXR.E316369 Control - CC-Link Patchcord Certificate Field - CC-Link Patchcord Certificate TSN - CC-Link Patchcord Certificate
Engineering Data	CAD data – STEP
Product Change Notification	PCN-PB47-20180213-00-A_EN PCN-PB47-20180213-00-A_DE Technische Änderung zu der Cabinet Line (RJ45 CAT.6A Patchkabel LSZH) Technical change to RJ45 CabinetLine (RJ45 CAT.6A Patchcable LSZH)
User Documentation	MAN IE GUIDE DE MAN IE GUIDE EN
Catalogues	Catalogues in PDF-format
Brochures	FL FIELDWIRING EN PI PROFINET CABLING EN PI PROFINET CABLING EN

IE-C6FP8LM0200M40M40-M

Weidmüller Interface GmbH & Co. KG
Klingenbergstraße 26
D-32758 Detmold
Germany

www.weidmueller.com

Drawings**Wiring**

RJ45	1	white (orange)	1	RJ45
	2	orange	2	
	3	white (green)	3	
	4	blue	4	
	5	white (blue)	5	
	6	green	6	
	7	white (brown)	7	
	8	brown	8	

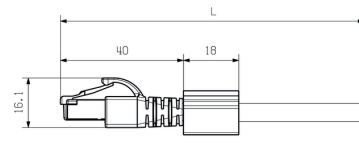
Dimensioned drawing

IE-C6FP8LM0200M40M40-M**Weidmüller Interface GmbH & Co. KG**

Klingenbergstraße 26

D-32758 Detmold

Germany

www.weidmueller.com**Accessories****Blank**

TM-I is an acknowledged and accredited marker type for traffic engineering applications. There are various different tag lengths available for individual labelling with long character strings. Easy handling of separation and installation thanks to the project marker field. Pre-attachment of sleeves and retrofitting of tags offer excellent versatility

The special contour of TM-I allows easy assembly and secures firm positioning. They are compatible with a number of commercially available sleeves. Thanks to the MultiCard format, the tags can be printed quickly and conveniently with the PrintJet CONNECT, plotter or the STI pen.

- Easy handling of separation and installation thanks to the project marker field.
- Acknowledged and accredited marker for traffic engineering applications
- Pre-attachment of sleeves and retrofitting of tags offer excellent versatility
- Not suited for labelling with P-Ink or STI pen in connection with CLI T sleeves

For custom printing: Please send us a file of our labeling software M-Print PRO or M-Print PRO Online (without installation) for your labeling specifications.

General ordering data

Type	TM-I 18 MC NE WS	Version
Order No.	1718431044	TM-I, Insert markers, 18 x 4 mm, white
GTIN (EAN)	4008190349011	
Qty.	320 pc(s).	

IE-C6FP8LM0200M40M40-M**Weidmüller Interface GmbH & Co. KG**

Klingenbergstraße 26

D-32758 Detmold

Germany

www.weidmueller.com**Accessories****Blank**

TM-I is an acknowledged and accredited marker type for traffic engineering applications. There are various different tag lengths available for individual labelling with long character strings. Easy handling of separation and installation thanks to the project marker field. Pre-attachment of sleeves and retrofitting of tags offer excellent versatility

The special contour of TM-I allows easy assembly and secures firm positioning. They are compatible with a number of commercially available sleeves. Thanks to the MultiCard format, the tags can be printed quickly and conveniently with the PrintJet CONNECT, plotter or the STI pen.

- Easy handling of separation and installation thanks to the project marker field.
- Acknowledged and accredited marker for traffic engineering applications
- Pre-attachment of sleeves and retrofitting of tags offer excellent versatility
- Not suited for labelling with P-Ink or STI pen in connection with CLI T sleeves

For custom printing: Please send us a file of our labeling software M-Print PRO or M-Print PRO Online (without installation) for your labeling specifications.

General ordering data

Type	TM-I 12 MC NE WS	Version
Order No.	1718411044	TM-I, Insert markers, 12 x 4 mm, white
GTIN (EAN)	4008190348977	
Qty.	320 pc(s).	