

**IE-C5ES8VG0010M40M40-G****Weidmüller Interface GmbH & Co. KG**

Klingenbergstraße 26

D-32758 Detmold

Germany

[www.weidmueller.com](http://www.weidmueller.com)

Assembled cables, patch cable Cabinet Line, Cat. 5, PVC,  
green

**General ordering data**

Version	System cable, RJ45 IP 20, RJ45 IP 20, Cat.5 (ISO/IEC 11801), PVC, 1 m
Order No.	<a href="#">1166020010</a>
Type	IE-C5ES8VG0010M40M40-G
GTIN (EAN)	4032248956814
Qty.	1 pc(s).

## IE-C5ES8VG0010M40M40-G

Weidmüller Interface GmbH &amp; Co. KG

Klingenbergstraße 26

D-32758 Detmold

Germany

www.weidmueller.com

## Technical data

## Dimensions and weights

Length	1 m	Length (inches)	39.37 inch
Net weight	55 g		

## Temperatures

Operating temperature	-40 °C...75 °C
-----------------------	----------------

## Cable specific standards

Generic communication cable facilities	ISO / IEC 11801:2002, EN 50173-1:2007	Standard, assembly	UL-Style 2879 (80°C/30V)
Standard, insulating material	DIN EN 50290-2-23 (VDE 0819) Table 2/A (HD 624.3)	Standard, shielding material	DIN EN 13602 Cu-ETP-A..B
Standard, wire material	DIN EN 13602 Cu-ETP-A		

## Electrical properties

PoE / PoE+	conforming to IEEE 802.3at
------------	----------------------------

## General standards

Connector standard	IEC 60603-7-51
--------------------	----------------

## Standards

Connector standard	IEC 60603-7-51	Generic communication cable facilities	ISO / IEC 11801:2002, EN 50173-1:2007
Standard, assembly	UL-Style 2879 (80°C/30V)	Standard, insulating material	DIN EN 50290-2-23 (VDE 0819) Table 2/A (HD 624.3)
Standard, shielding material	DIN EN 13602 Cu-ETP-A..B	Standard, wire material	DIN EN 13602 Cu-ETP-A

## Cable structure

Arrangement of wire cores	Twisted pair	Colour sequence or wires - wire pairs	white/blue - blue, white/ orange - orange, white/ green - green, white/ brown - brown
Complete shielding	Shielding braid made from copper wiring	Cross-section	4*2*AWG 26/7 - 4*2*0.128 mm <sup>2</sup>
Diameter of wire pair	2.4 mm	Insulation	PE
Insulation cross-section	0.98 mm	Material sheath	PVC
Number of wires	8	Overlap of shielding braid	70 %
Sheath diameter, max.	5.8 mm	Sheath diameter, min.	5.4 mm
Sheathing colour	green (RAL 6018)	Sheathing material thickness	0.5 mm
Shielding	SF/UTP	Shielding braid thickness	0.1 mm
Standard designations	LI02YSCY 4X2X0.15 PIMF GN, SF/UTP	Strands	7
Wire core insulation thickness	0.25 mm	Wire material	Stranded tin-plated copper wire
Wire pair shielding	Aluminium foil, Plastic foil		

## IE-C5ES8VG0010M40M40-G

Weidmüller Interface GmbH &amp; Co. KG

Klingenbergstraße 26

D-32758 Detmold

Germany

www.weidmueller.com

## Technical data

## Electrical properties of cable

Capacity at 1 kHz	48 nF/km	Category	Cat.5 (ISO/IEC 11801)
Characteristic impedance	100 ± 5 Ω at 100MHz	Delay skew	25 ns/100m
Loop resistance	150 Ω/km	Operating voltage (UL rating)	30 V
Operating voltage, UL	30 V	Resistance differential	3 %
Shield attenuation	55 dB at 30–600 MHz	Signal propagation time	5.13 ns/m
Test voltage: wire-wire-shield		Transfer impedance	15 mΩ/m at 1 MHz, 20 mΩ/m at 10 MHz, 30 mΩ/m at 30 MHz
	750 V DC, 1 min		
Transmission rate	10/100 MBit/s, 1000 MBit/s		

## Mechanical and material properties of cable

Abrasion resistance	good	Halogen	Yes
Min. bending radius, once only	5 x cable diameter	Min. bending radius, repetitive	10 x cable diameter
Resistance to spread of flame	in accordance with IEC 60332-1		

## Plug

Plug left	RJ45, IP20, male contact, straight, plug, Plastic, shielded	Plug right	RJ45, IP20, male contact, straight, plug, Plastic, shielded
-----------	---	------------	---

## Plug, left

Plug left	RJ45, IP20, male contact, straight, plug, Plastic, shielded
-----------	---

## Plug, right

Plug right	RJ45, IP20, male contact, straight, plug, Plastic, shielded
------------	---

## Classifications

ETIM 6.0	EC002599	ETIM 7.0	EC002599
ETIM 8.0	EC002599	ETIM 9.0	EC002599
ECLASS 9.0	27-06-03-08	ECLASS 9.1	27-06-03-08
ECLASS 10.0	27-06-03-08	ECLASS 11.0	27-06-03-08
ECLASS 12.0	27-06-03-08	ECLASS 13.0	27-06-03-08
ECLASS 14.0	27-06-03-08		

## Environmental Product Compliance

REACH SVHC	/
RoHS Compliance Status	Compliant without exemption

**IE-C5ES8VG0010M40M40-G****Weidmüller Interface GmbH & Co. KG**

Klingenbergstraße 26

D-32758 Detmold

Germany

[www.weidmueller.com](http://www.weidmueller.com)**Technical data****Approvals**

Approvals



ROHS

Conform

**Downloads**

Engineering Data	<a href="#">CAD data – STEP</a>
Product Change Notification	<a href="#">PCN-PB47-20180213-00-A_EN</a> <a href="#">PCN-PB47-20180213-00-A_DE</a>
User Documentation	<a href="#">MAN IE GUIDE DE</a> <a href="#">MAN IE GUIDE EN</a>
Catalogues	<a href="#">Catalogues in PDF-format</a>
Brochures	<a href="#">FL FIELDWIRING EN</a> <a href="#">PI PROFINET CABLING EN</a> <a href="#">PI PROFINET CABLING EN</a>

**IE-C5ES8VG0010M40M40-G****Weidmüller Interface GmbH & Co. KG**

Klingenbergstraße 26

D-32758 Detmold

Germany

[www.weidmueller.com](http://www.weidmueller.com)**Drawings****Wiring**

RJ45	1	white, orange	1	RJ45
	2	orange	2	
	3	white, green	3	
	4	blue	4	
	5	white, blue	5	
	6	green	6	
	7	white, brown	7	
	8	brown	8	

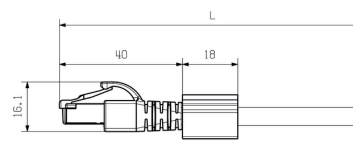
**Dimensioned drawing**

**IE-C5ES8VG0010M40M40-G****Weidmüller Interface GmbH & Co. KG**

Klingenbergstraße 26

D-32758 Detmold

Germany

[www.weidmueller.com](http://www.weidmueller.com)**Accessories****Blank**

TM-I is an acknowledged and accredited marker type for traffic engineering applications. There are various different tag lengths available for individual labelling with long character strings. Easy handling of separation and installation thanks to the project marker field. Pre-attachment of sleeves and retrofitting of tags offer excellent versatility

The special contour of TM-I allows easy assembly and secures firm positioning. They are compatible with a number of commercially available sleeves. Thanks to the MultiCard format, the tags can be printed quickly and conveniently with the PrintJet CONNECT, plotter or the STI pen.

- Easy handling of separation and installation thanks to the project marker field.
- Acknowledged and accredited marker for traffic engineering applications
- Pre-attachment of sleeves and retrofitting of tags offer excellent versatility
- Not suited for labelling with P-Ink or STI pen in connection with CLI T sleeves

**For custom printing:** Please send us a file of our labeling software M-Print PRO or M-Print PRO Online (without installation) for your labeling specifications.

**General ordering data**

Type	TM-I 12 MC NE WS	Version
Order No.	<a href="#">1718411044</a>	TM-I, Insert markers, 12 x 4 mm, white
GTIN (EAN)	4008190348977	
Qty.	320 pc(s).	

**IE-C5ES8VG0010M40M40-G****Weidmüller Interface GmbH & Co. KG**

Klingenbergstraße 26

D-32758 Detmold

Germany

[www.weidmueller.com](http://www.weidmueller.com)**Accessories****Blank**

TM-I is an acknowledged and accredited marker type for traffic engineering applications. There are various different tag lengths available for individual labelling with long character strings. Easy handling of separation and installation thanks to the project marker field. Pre-attachment of sleeves and retrofitting of tags offer excellent versatility

The special contour of TM-I allows easy assembly and secures firm positioning. They are compatible with a number of commercially available sleeves. Thanks to the MultiCard format, the tags can be printed quickly and conveniently with the PrintJet CONNECT, plotter or the STI pen.

- Easy handling of separation and installation thanks to the project marker field.
- Acknowledged and accredited marker for traffic engineering applications
- Pre-attachment of sleeves and retrofitting of tags offer excellent versatility
- Not suited for labelling with P-Ink or STI pen in connection with CLI T sleeves

**For custom printing:** Please send us a file of our labeling software M-Print PRO or M-Print PRO Online (without installation) for your labeling specifications.

**General ordering data**

Type	TM-I 18 MC NE WS	Version
Order No.	<a href="#">1718431044</a>	TM-I, Insert markers, 18 x 4 mm, white
GTIN (EAN)	4008190349011	
Qty.	320 pc(s).	