

**IE-C5ES8UG0003M40M40-G****Weidmüller Interface GmbH & Co. KG**

Klingenbergstraße 26

D-32758 Detmold

Germany

[www.weidmueller.com](http://www.weidmueller.com)

Assembled cables, patch cable Cabinet Line, Cat. 5, PUR,  
green

**General ordering data**

Version	System cable, RJ45 IP 20, RJ45 IP 20, Cat.5 (ISO/IEC 11801), PUR, 0.3 m
Order No.	<a href="#">1166000003</a>
Type	IE-C5ES8UG0003M40M40-G
GTIN (EAN)	4050118200508
Qty.	1 pc(s).

**IE-C5ES8UG0003M40M40-G****Weidmüller Interface GmbH & Co. KG**

Klingenbergstraße 26

D-32758 Detmold

Germany

www.weidmueller.com

**Technical data****Dimensions and weights**

Length	0.3 m	Length (inches)	11.811 inch
Net weight	29 g		

**Temperatures**

Operating temperature	-40 °C...75 °C	Installation temperature	-10 °C...60 °C
-----------------------	----------------	--------------------------	----------------

**General standards**

Certificate no. (cULus)	E316369
-------------------------	---------

**Cable structure**

Arrangement of wire cores	Colour sequence or wires - wire pairs	white/blue - blue, white/ orange - orange, white/ green - green, white/ brown - brown
Complete shielding	Twisted pair Shielding braid made from copper wiring	Cross-section 4*2*AWG 26/7 - 4*2*0.128 mm <sup>2</sup>
Insulation	PE	Insulation cross-section 0.98 mm
Material sheath	PUR	Number of wires 8
Sheath diameter, max.	6 mm	Sheath diameter, min. 5.6 mm
Sheathing colour	green	Shielding SF/UTP
Strands	7	Wire material Stranded tin-plated copper wire
Wire pair shielding	Aluminium foil	

**Electrical properties of cable**

Category	Cat.5 (ISO/IEC 11801)	Test voltage: wire-wire-shield	750 V DC, 1 min
Transmission rate	10/100 MBit/s, 1000 MBit/s		

**Mechanical and material properties of cable**

Abrasion resistance	very good	Halogen	halogen-free, according to IEC 60754-2
Min. bending radius, once only	5 x cable diameter	Min. bending radius, repetitive	10 x cable diameter
Resistance to oils	EN 50305	Resistance to spread of flame	in accordance with IEC 60332-1
Silicone-free	Yes	UV-resistant	Yes

**Plug**

Plug left	RJ45, IP20, male con- tact, straight, plug, Plastic, shielded	Plug right	RJ45, IP20, male con- tact, straight, plug, Plastic, shielded
-----------	---	------------	---

**Plug, left**

Plug left	RJ45, IP20, male con- tact, straight, plug, Plastic, shielded
-----------	---

## IE-C5ES8UG0003M40M40-G

Weidmüller Interface GmbH &amp; Co. KG

Klingenbergstraße 26

D-32758 Detmold

Germany

[www.weidmueller.com](http://www.weidmueller.com)

## Technical data

## Plug, right

Plug right	RJ45, IP20, male contact, straight, plug, Plastic, shielded
------------	---

## Classifications

ETIM 6.0	EC002599	ETIM 7.0	EC002599
ETIM 8.0	EC002599	ETIM 9.0	EC002599
ECLASS 9.0	27-06-03-08	ECLASS 9.1	27-06-03-08
ECLASS 10.0	27-06-03-08	ECLASS 11.0	27-06-03-08
ECLASS 12.0	27-06-03-08	ECLASS 13.0	27-06-03-08

## Environmental Product Compliance

REACH SVHC	/
------------	---

## Approvals

Approvals



ROHS	Conform
UL File Number Search	UL Website
Certificate no. (cULus)	E316369

## Downloads

Engineering Data	<a href="#">CAD data – STEP</a>
Product Change Notification	<a href="#">PCN-PB47-20180213-00-A_EN</a> <a href="#">PCN-PB47-20180213-00-A_DE</a>
User Documentation	<a href="#">MAN IE GUIDE DE</a> <a href="#">MAN IE GUIDE EN</a>
Catalogues	<a href="#">Catalogues in PDF-format</a>
Brochures	<a href="#">FL FIELDWIRING EN</a> <a href="#">PI PROFINET CABLING EN</a>

**IE-C5ES8UG0003M40M40-G****Weidmüller Interface GmbH & Co. KG**

Klingenbergstraße 26

D-32758 Detmold

Germany

[www.weidmueller.com](http://www.weidmueller.com)**Drawings****Wiring**

RJ45	1	white, orange	1	RJ45
	2	orange	2	
	3	white, green	3	
	4	blue	4	
	5	white, blue	5	
	6	green	6	
	7	white, brown	7	
	8	brown	8	

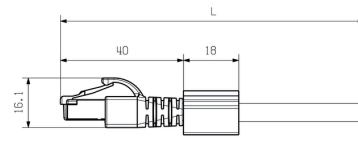
**Dimensioned drawing**

**IE-C5ES8UG0003M40M40-G****Weidmüller Interface GmbH & Co. KG**

Klingenbergstraße 26

D-32758 Detmold

Germany

[www.weidmueller.com](http://www.weidmueller.com)**Accessories****Blank**

TM-I is an acknowledged and accredited marker type for traffic engineering applications. There are various different tag lengths available for individual labelling with long character strings. Easy handling of separation and installation thanks to the project marker field. Pre-attachment of sleeves and retrofitting of tags offer excellent versatility

The special contour of TM-I allows easy assembly and secures firm positioning. They are compatible with a number of commercially available sleeves. Thanks to the MultiCard format, the tags can be printed quickly and conveniently with the PrintJet CONNECT, plotter or the STI pen.

- Easy handling of separation and installation thanks to the project marker field.
- Acknowledged and accredited marker for traffic engineering applications
- Pre-attachment of sleeves and retrofitting of tags offer excellent versatility
- Not suited for labelling with P-Ink or STI pen in connection with CLI T sleeves

**For custom printing:** Please send us a file of our labeling software M-Print PRO or M-Print PRO Online (without installation) for your labeling specifications.

**General ordering data**

Type	TM-I 12 MC NE WS	Version
Order No.	<a href="#">1718411044</a>	TM-I, Insert markers, 12 x 4 mm, white
GTIN (EAN)	4008190348977	
Qty.	320 pc(s).	

**IE-C5ES8UG0003M40M40-G****Weidmüller Interface GmbH & Co. KG**

Klingenbergstraße 26

D-32758 Detmold

Germany

[www.weidmueller.com](http://www.weidmueller.com)**Accessories****Blank**

TM-I is an acknowledged and accredited marker type for traffic engineering applications. There are various different tag lengths available for individual labelling with long character strings. Easy handling of separation and installation thanks to the project marker field. Pre-attachment of sleeves and retrofitting of tags offer excellent versatility

The special contour of TM-I allows easy assembly and secures firm positioning. They are compatible with a number of commercially available sleeves. Thanks to the MultiCard format, the tags can be printed quickly and conveniently with the PrintJet CONNECT, plotter or the STI pen.

- Easy handling of separation and installation thanks to the project marker field.
- Acknowledged and accredited marker for traffic engineering applications
- Pre-attachment of sleeves and retrofitting of tags offer excellent versatility
- Not suited for labelling with P-Ink or STI pen in connection with CLI T sleeves

**For custom printing:** Please send us a file of our labeling software M-Print PRO or M-Print PRO Online (without installation) for your labeling specifications.

**General ordering data**

Type	TM-I 18 MC NE WS	Version
Order No.	<a href="#">1718431044</a>	TM-I, Insert markers, 18 x 4 mm, white
GTIN (EAN)	4008190349011	
Qty.	320 pc(s).	