

**IE-C6FP8LD0005M40M40-D****Weidmüller Interface GmbH & Co. KG**

Klingenbergstraße 26

D-32758 Detmold

Germany

[www.weidmueller.com](http://www.weidmueller.com)

Assembled IE cables, patch cable Cabinet Line, Cat. 6,  
LSZH, grey

**General ordering data**

|            |   |
|------------|---|
| Version    | Patch cable, RJ45 IP 20, RJ45 IP 20, <20 m:<br>Cat.6A / >20 m Class EA (ISO/IEC 11801 2010),<br>LSZH, 0.5 m |
| Order No.  | <a href="#">1165940005</a>  |
| Type       | IE-C6FP8LD0005M40M40-D  |
| GTIN (EAN) | 403224895608 1  |
| Qty.       | 1 pc(s).  |

## IE-C6FP8LD0005M40M40-D

Weidmüller Interface GmbH &amp; Co. KG

Klingenbergstraße 26

D-32758 Detmold

Germany

www.weidmueller.com

## Technical data

## Dimensions and weights

|            |       |                 |             |
|------------|-------|-----------------|-------------|
| Length     | 0.5 m | Length (inches) | 19.685 inch |
| Net weight | 34 g  |                 |             |

## Temperatures

|                          |                |                       |                |
|--------------------------|----------------|-----------------------|----------------|
| Storage temperature      | -20 °C...60 °C | Operating temperature | -20 °C...60 °C |
| Installation temperature | 0 °C...50 °C   |                       |                |

## Electrical properties

|                                    |     |            |                            |
|------------------------------------|-----|------------|----------------------------|
| Current-carrying capacity at 50 °C | 1 A | PoE / PoE+ | conforming to IEEE 802.3at |
|------------------------------------|-----|------------|----------------------------|

## General standards

|   |   |                         |         |
|---|---|-------------------------|---------|
| Application-specific communication cable facilities | ANSI / TIA / EIA-568-B.2-10, ISO / IEC 11801:2002, EN50173-1:2007 | Certificate no. (cULus) | E316369 |
| Connector standard                                  | IEC 60603-7-51  |                         |         |

## Standards

|                    |                |
|--------------------|----------------|
| Connector standard | IEC 60603-7-51 |
|--------------------|----------------|

## Cable structure

|                            |   |                                       |  |
|----------------------------|---|---------------------------------------|--|
| Arrangement of wire cores  | Twisted pair                            | Colour sequence or wires - wire pairs | white - blue, white - orange, white - green, white - brown |
| Complete shielding         | Shielding braid made from copper wiring | Cross-section                         | 4*2*AWG 27/7 - 4*2*0.1 mm <sup>2</sup>                     |
| Insulation                 | PE                                      | Insulation cross-section              | 1.04 mm  |
| Material sheath            | LSZH                                    | Number of wires                       | 8  |
| Overlap of shielding braid | 60 %                                    | Sheath diameter, max.                 | 5.9 mm   |
| Sheath diameter, min.      | 5.5 mm                                  | Sheathing colour                      | grey   |
| Shielding                  | S/FTP                                   | Strands                               | 7  |
| Wire pair shielding        | Aluminium foil                          |                                       |  |

## Electrical properties of cable

|                                   |                         |  |   |
|-----------------------------------|-------------------------|--|---|
| Capacity at 1 kHz                 | 46 nF/km                | Category                                 | <20 m: Cat.6A / >20 m Class EA (ISO/IEC 11801 2010) |
| Characteristic impedance          | 100 ± 15 Ω at 1–100 MHz | Coupling attenuation up to 1000 MHz      | 80 dB   |
| Coupling resistance at 10 MHz / m | 5 mΩ                    | Delay skew                               | 2.5 ns/100m   |
| Operating voltage                 | 50 V DC                 | Operating voltage (UL rating)            | 30 V AC / 42.4 V DC                                 |
| Resistance differential           | 5 %                     | Separating class according to EN 50174-2 | d   |
| Test voltage: wire-wire-shield    | 2.5 kV / DC for 2 sec   | Transmission rate                        | 10 Gbit/s   |

## IE-C6FP8LD0005M40M40-D

Weidmüller Interface GmbH &amp; Co. KG

Klingenbergstraße 26

D-32758 Detmold

Germany

www.weidmueller.com

## Technical data

## Mechanical and material properties of cable

|                                |                    |                               |   |
|--------------------------------|--------------------|-------------------------------|---|
| Colour                         | grey               | Halogen                       | halogen-free, according to IEC 60754-2  |
| Min. bending radius, once only |                    | Resistance to spread of flame | in accordance with IEC 60332-2-2, in accordance with IEC 60332-1-2, in accordance with IEC 60332-3-24, in accordance with UL 2556 (FT1) |
|                                | 4 x cable diameter |                               |   |

## Plug

|           |   |            |   |
|-----------|---|------------|---|
| Plug left | RJ45, IP20, male contact, straight, plug, Plastic, shielded | Plug right | RJ45, IP20, male contact, straight, plug, Plastic, shielded |
|-----------|---|------------|---|

## Plug, left

|           |   |
|-----------|---|
| Plug left | RJ45, IP20, male contact, straight, plug, Plastic, shielded |
|-----------|---|

## Plug, right

|            |   |
|------------|---|
| Plug right | RJ45, IP20, male contact, straight, plug, Plastic, shielded |
|------------|---|

## Classifications

|             |             |             |             |
|-------------|-------------|-------------|-------------|
| ETIM 6.0    | EC002599    | ETIM 7.0    | EC002599    |
| ETIM 8.0    | EC002599    | ETIM 9.0    | EC002599    |
| ECLASS 9.0  | 27-06-03-08 | ECLASS 9.1  | 27-06-03-08 |
| ECLASS 10.0 | 27-06-03-08 | ECLASS 11.0 | 27-06-03-08 |
| ECLASS 12.0 | 27-06-03-08 | ECLASS 13.0 | 27-06-03-08 |

## Environmental Product Compliance

|            |   |
|------------|---|
| REACH SVHC | / |
|------------|---|

## Approvals

Approvals



|                         |            |
|-------------------------|------------|
| ROHS                    | Conform    |
| UL File Number Search   | UL Website |
| Certificate no. (cULus) | E316369    |

**IE-C6FP8LD0005M40M40-D****Weidmüller Interface GmbH & Co. KG**

Klingenbergstraße 26

D-32758 Detmold

Germany

[www.weidmueller.com](http://www.weidmueller.com)**Technical data****Downloads**

|   |   |
|---|---|
| Approval/Certificate/Document of Conformity | <a href="#">ISO/IEC EN and TIA/EIA Screened Class EA Category 6A, 2 connector channel DUXR.E316369</a><br><a href="#">Control - CC-Link Patchcord Certificate</a><br><a href="#">Field - CC-Link Patchcord Certificate</a><br><a href="#">TSN - CC-Link Patchcord Certificate</a> |
| Engineering Data                            | <a href="#">CAD data – STEP</a>   |
| Engineering Data                            | <a href="#">Zuken E3.S</a>  |
| Product Change Notification                 | <a href="#">PCN-PB47-20180213-00-A_EN</a><br><a href="#">PCN-PB47-20180213-00-A_DE</a><br><a href="#">Technische Änderung zu der Cabinet Line (RJ45 CAT.6A Patchkabel LSZH)</a><br><a href="#">Technical change to RJ45 CabinetLine (RJ45 CAT.6A Patchcable LSZH)</a>             |
| User Documentation                          | <a href="#">MAN IE GUIDE DE</a><br><a href="#">MAN IE GUIDE EN</a>  |
| Catalogues                                  | <a href="#">Catalogues in PDF-format</a>  |
| Brochures                                   | <a href="#">FL FIELDWIRING EN</a><br><a href="#">PI PROFINET CABLING EN</a><br><a href="#">PI PROFINET CABLING EN</a>   |

**IE-C6FP8LD0005M40M40-D**

**Weidmüller Interface GmbH & Co. KG**  
Klingenbergstraße 26  
D-32758 Detmold  
Germany

[www.weidmueller.com](http://www.weidmueller.com)

**Drawings****Wiring**

|      |   |                |   |      |
|------|---|----------------|---|------|
| RJ45 | 1 | white (orange) | 1 | RJ45 |
|      | 2 | orange         | 2 |      |
|      | 3 | white (green)  | 3 |      |
|      | 4 | blue           | 4 |      |
|      | 5 | white (blue)   | 5 |      |
|      | 6 | green          | 6 |      |
|      | 7 | white (brown)  | 7 |      |
|      | 8 | brown          | 8 |      |

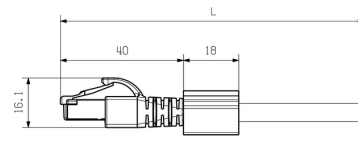
**Dimensioned drawing**

**IE-C6FP8LD0005M40M40-D****Weidmüller Interface GmbH & Co. KG**

Klingenbergstraße 26

D-32758 Detmold

Germany

[www.weidmueller.com](http://www.weidmueller.com)**Accessories****Blank**

TM-I is an acknowledged and accredited marker type for traffic engineering applications. There are various different tag lengths available for individual labelling with long character strings. Easy handling of separation and installation thanks to the project marker field. Pre-attachment of sleeves and retrofitting of tags offer excellent versatility

The special contour of TM-I allows easy assembly and secures firm positioning. They are compatible with a number of commercially available sleeves. Thanks to the MultiCard format, the tags can be printed quickly and conveniently with the PrintJet CONNECT, plotter or the STI pen.

- Easy handling of separation and installation thanks to the project marker field.
- Acknowledged and accredited marker for traffic engineering applications
- Pre-attachment of sleeves and retrofitting of tags offer excellent versatility
- Not suited for labelling with P-Ink or STI pen in connection with CLI T sleeves

**For custom printing:** Please send us a file of our labeling software M-Print PRO or M-Print PRO Online (without installation) for your labeling specifications.

**General ordering data**

|            |                            |  |
|------------|----------------------------|--|
| Type       | TM-I 12 MC NE WS           | Version                                |
| Order No.  | <a href="#">1718411044</a> | TM-I, Insert markers, 12 x 4 mm, white |
| GTIN (EAN) | 4008190348977              |  |
| Qty.       | 320 pc(s).                 |  |

**IE-C6FP8LD0005M40M40-D****Weidmüller Interface GmbH & Co. KG**

Klingenbergstraße 26

D-32758 Detmold

Germany

[www.weidmueller.com](http://www.weidmueller.com)**Accessories****Blank**

TM-I is an acknowledged and accredited marker type for traffic engineering applications. There are various different tag lengths available for individual labelling with long character strings. Easy handling of separation and installation thanks to the project marker field. Pre-attachment of sleeves and retrofitting of tags offer excellent versatility

The special contour of TM-I allows easy assembly and secures firm positioning. They are compatible with a number of commercially available sleeves. Thanks to the MultiCard format, the tags can be printed quickly and conveniently with the PrintJet CONNECT, plotter or the STI pen.

- Easy handling of separation and installation thanks to the project marker field.
- Acknowledged and accredited marker for traffic engineering applications
- Pre-attachment of sleeves and retrofitting of tags offer excellent versatility
- Not suited for labelling with P-Ink or STI pen in connection with CLI T sleeves

**For custom printing:** Please send us a file of our labeling software M-Print PRO or M-Print PRO Online (without installation) for your labeling specifications.

**General ordering data**

|            |                            |  |
|------------|----------------------------|--|
| Type       | TM-I 18 MC NE WS           | Version                                |
| Order No.  | <a href="#">1718431044</a> | TM-I, Insert markers, 18 x 4 mm, white |
| GTIN (EAN) | 4008190349011              |  |
| Qty.       | 320 pc(s).                 |  |