

HDC IP68 06B TOS 1M32**Weidmüller Interface GmbH & Co. KG**

Klingenbergstraße 26

D-32758 Detmold

Germany

www.weidmueller.com**IP68**

The new RockStar® enclosures are resistant to seawater and offer a high degree of shock resistance, meet IP 68 and IP 69K, and have been developed for use under extreme environmental conditions and designed for the high vibration requirements acc. to DIN EN 61373 cat. 2 (bogie). As such, this housing family is ideally suited for fault- and maintenance-free operation of heavy-duty connectors in transport and traffic engineering as well as in power engineering and in applications with extreme requirements. During development, measures were also implemented to make the enclosures extremely EMC-resistant.

General ordering data

Version	HDC enclosures, Size: 3, Protection degree: IP69K, IP68 (in plugged condition), IP66 (in plugged condition), Plug housing, Clamping yoke connection, Standard, Size of cable entries: M 32
Order No.	1082440000
Type	HDC IP68 06B TOS 1M32
GTIN (EAN)	4032248845613
Qty.	1 pc(s).

HDC IP68 06B TOS 1M32

Weidmüller Interface GmbH & Co. KG

Klingenbergstraße 26

D-32758 Detmold

Germany

www.weidmueller.com

Technical data

Dimensions and weights

Height	100 mm	Height (inches)	3.937 inch
Width	58 mm	Width (inches)	2.283 inch
Net weight	428.1 g		

Temperatures

Limit temperature	-50 °C ... 125 °C
-------------------	-------------------

Dimensions

Cable entry	w. thread	Height of housing B	100 mm
Total length housing	132 mm		

General data

EMC housings	Yes	Housing main material	diecast aluminium
Material of locking element		Protection degree	IP69K, IP68 (in plugged condition), IP66 (in plugged condition)
	Stainless steel, rust-proof		
Surface finish	Powder coating	Tightening torque	6.5 Nm

Version

BG	3	Cable entry	w. thread
Clamp version	Clamping yoke connection	Colour (RAL)	RAL 9011, RAL 9005
Design	Standard	Design of housing	Plug housing
Design of locking system	Clamping yoke connection	Internal thread	M 32
Number of cable entry on top	1	Number of cable entry sideways	0
Size	3	Size of cable entries	M 32
Suitable for ModuPlug®	Yes	Tightening torque	6.5 Nm
Top part/bottom part/lid	upper part	Type	Plug

Classifications

ETIM 6.0	EC000437	ETIM 7.0	EC000437
ETIM 8.0	EC000437	ETIM 9.0	EC000437
ECLASS 9.0	27-44-02-02	ECLASS 9.1	27-44-02-02
ECLASS 10.0	27-44-02-02	ECLASS 11.0	27-44-02-02
ECLASS 12.0	27-44-02-02	ECLASS 13.0	27-44-02-02
ECLASS 14.0	27-44-02-02		

Substance	Acetone
Chemical resistance	Resistant
Substance	Diesel oil
Chemical resistance	Unstable
Substance	Ethyl alcohol
Chemical resistance	Resistant
Substance	Transmission oil
Chemical resistance	Conditionally resistant
Substance	Hydraulic oil
Chemical resistance	Conditionally resistant

Creation date October 4, 2024 5:09:30 AM CEST

HDC IP68 06B TOS 1M32

Weidmüller Interface GmbH & Co. KG

Klingenbergstraße 26

D-32758 Detmold

Germany

www.weidmueller.com

Technical data

Substance	Petroleum benzine
Chemical resistance	Unstable
Substance	Sweat
Chemical resistance	Conditionally resistant
Substance	Premium gasoline
Chemical resistance	Unstable
Substance	Water
Chemical resistance	Resistant
Substance	UV
Chemical resistance	Resistant
Substance	Ozone
Chemical resistance	Resistant

Environmental Product Compliance

REACH SVHC	/
Chemical resistance	de.myview.objectmodel.impl.BlockImpl@67b50042 de.myview.objectmodel.impl.BlockImpl@5d630dc3 de.myview.objectmodel.impl.BlockImpl@1ac622c1 de.myview.objectmodel.impl.BlockImpl@6ed70caf de.myview.objectmodel.impl.BlockImpl@212fa627 de.myview.objectmodel.impl.BlockImpl@6467bad4 de.myview.objectmodel.impl.BlockImpl@4f1c4cb3 de.myview.objectmodel.impl.BlockImpl@1978938b de.myview.objectmodel.impl.BlockImpl@453a101d de.myview.objectmodel.impl.BlockImpl@1cd2b374 de.myview.objectmodel.impl.BlockImpl@31861d89
RoHS Compliance Status	Compliant without exemption

Approvals

Approvals



ROHS	Conform
------	---------

Downloads

Approval/Certificate/Document of Conformity	Manufacturer's declaration
Engineering Data	CAD data – STEP
Product Change Notification	20220214 Technical change to HDC housings 20220214 Technische Änderung bei HDC-Gehäusen
Catalogues	Catalogues in PDF-format
Brochures	FL FIELDWIRING EN FL FIELDWIRING EN

HDC IP68 06B TOS 1M32

Weidmüller Interface GmbH & Co. KG
Klingenbergstraße 26
D-32758 Detmold
Germany

www.weidmueller.com

Drawings

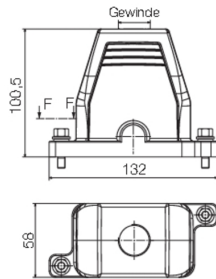

HDC IP68 06B TOS 1M32**Weidmüller Interface GmbH & Co. KG**

Klingenbergstraße 26

D-32758 Detmold

Germany

www.weidmueller.com**Accessories****Screws**

We offer a variety of accessories, including screws, that fit to the heavy-duty connectors.

**General ordering data**

Type	HDC IP68 SCREW SET	Version
Order No.	2555340000	Heavy-duty connectors, Accessories, Set of fixings
GTIN (EAN)	4050118571332	
Qty.	10 pc(s).	

Socket wrench sets

Allen key made from fully hardened, high-alloy chromium-vanadium- steel, acc. to DIN ISO 2936 L (DIN 911), high-quality refined surface.

**General ordering data**

Type	SK WSD-S 1,5-10,0	Version
Order No.	9008850000	Mounting tool
GTIN (EAN)	4032248266609	
Qty.	1 pc(s).	