

IE-C5DD4UG0500MCSA70-E**Weidmüller Interface GmbH & Co. KG**

Klingenbergstraße 26

D-32758 Detmold

Germany

www.weidmueller.com

Assembled IE cables, PROFINET, Cat. 5, PUR, green, drag-chain compatible, M12-RJ45

General ordering data

Version	Dragline cable, PROFINET, M12 D-code – IP 67 straight pin, RJ45 IP 20, Cat.5 (ISO/IEC 11801) / Cat.5e (TIA T568-B), PUR, 50 m
Order No.	1044470500
Type	IE-C5DD4UG0500MCSA70-E
GTIN (EAN)	4050118185300
Qty.	1 pc(s).
Available until	2013-12-06

IE-C5DD4UG0500MCSA70-E

Weidmüller Interface GmbH & Co. KG

Klingenbergstraße 26

D-32758 Detmold

Germany

www.weidmueller.com

Technical data

Dimensions and weights

Length	50 m	Length (inches)	1,968.504 inch
Net weight	3,143 g		

Temperatures

Storage temperature	-50 °C...70 °C	Operating temperature	-40 °C...70 °C
Installation temperature	-20 °C...60 °C		

Cable specific standards

Standard, insulating material	DIN EN 50290-2-23 (VDE 0819) Table 2/A (HD 624.3)	Standard, shielding material	DIN EN 13602 Cu-ETP-A..B
Standard, wire material	DIN EN 13602 Cu-ETP-A		

General standards

Certificate no. (cULus)	E316369
-------------------------	---------

Standards

Standard, insulating material	DIN EN 50290-2-23 (VDE 0819) Table 2/A (HD 624.3)	Standard, shielding material	DIN EN 13602 Cu-ETP-A..B
Standard, wire material	DIN EN 13602 Cu-ETP-A		

Cable structure

Arrangement of wire cores	Star-quad	Colour sequence or wires - wire pairs	white, yellow, blue, orange
Complete shielding	Aluminium foil, Shielding braid made from copper wiring	Cross-section	4*AWG 22/7 - 0.32 mm ²
Diameter of inner sheathing	3.9 mm	Filler	As central element
Insulation	PE	Insulation cross-section	1.5 mm
Material sheath	PUR	Number of wires	4
Overlap of shielding braid	85 %	Sheath diameter, max.	6.7 mm
Sheath diameter, min.	6.3 mm	Sheathing colour	green (RAL 6018)
Sheathing material thickness	0.9 mm	Shielding	SF/UTP
Shielding braid thickness	0.13 mm	Standard designations	2YH(ST)C11Y 2x2x0.75/1.5-100 LI VZN GN FRNC
Strands	7	Wire core insulation thickness	0.38 mm
Wire material	Stranded tin-plated copper wire		

Electrical properties of cable

Capacity at 1 kHz	52 nF/km	Category	Cat.5 (ISO/IEC 11801) / Cat.5e (TIA T568-B)
Characteristic impedance	100 ± 15 Ω at 1–100 MHz	Delay skew	40 ns/100m
Loop resistance	120 Ω/km	Operating voltage (UL rating)	600 V
Operating voltage, UL	600 V	Resistance differential	3 %
Signal propagation time	5.3 ns/m	Speed	180 m/min
Test voltage: wire-wire-shield	2000 V _{eff} , 50 Hz, 1 min	Transfer impedance	20 mΩ/m at 10 MHz

IE-C5DD4UG0500MCSA70-E

Weidmüller Interface GmbH & Co. KG

Klingenbergstraße 26

D-32758 Detmold

Germany

www.weidmueller.com

Technical data

Mechanical and material properties of cable

Abrasion resistance	very good	Acceleration	4 m/s ²
Bending cycles	3 Mio	Fire propagation	No
Halogen	halogen-free, according to IEC 60754-2	Min. bending radius, once only	5 x cable diameter
Min. bending radius, repetitive	7.5 x cable diameter	Pulling force	≤ 150 N
Resistance to oils	in accordance with IEC 60811-2-1	Resistance to spread of flame	in accordance with IEC 60332-1
Silicone-free	Yes	Speed	180 m/min
UV-resistant	Yes		

Plug, left

Plug left	M12, IP67, male contact, straight, plug, Plastic, shielded
-----------	--

Plug, right

Plug right	RJ45, IP20, male contact, straight, plug, Plastic, shielded
------------	---

Classifications

ETIM 6.0	EC002599	ETIM 7.0	EC002599
ETIM 8.0	EC002599	ETIM 9.0	EC002599
ECLASS 9.0	27-06-03-08	ECLASS 9.1	27-06-03-08
ECLASS 10.0	27-06-03-08	ECLASS 11.0	27-06-03-08
ECLASS 12.0	27-06-03-08	ECLASS 13.0	27-06-03-08

Environmental Product Compliance

REACH SVHC	Lead 7439-92-1
SCIP	67cf1078-beca-4687-860b-dc475a6ec24a

Approvals

Approvals



ROHS	Conform
UL File Number Search	UL Website
Certificate no. (cULus)	E316369

Downloads

Engineering Data	CAD data – STEP
Product Change Notification	PCN-PB47-20230322-A-EN PCN-PB47-20230322-A-DE
Catalogues	Catalogues in PDF-format

IE-C5DD4UG0500MCSA70-E

Weidmüller Interface GmbH & Co. KG
Klingenbergstraße 26
D-32758 Detmold
Germany

www.weidmueller.com

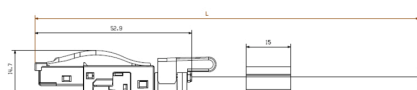
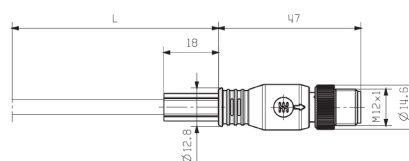
Drawings**Dimensioned drawing****Dimensioned drawing****Wiring**

RJ45		M12
1	yellow	1
3	white	2
2	orange	3
6	blue	4

IE-C5DD4UG0500MCSA70-E

Weidmüller Interface GmbH & Co. KG

Klingenbergstraße 26

D-32758 Detmold

Germany

www.weidmueller.com

Accessories

Screwty® cable gland tool



The ideal tool for any application

Screwty® is the ideal, all-purpose tool for tightening all common sensor and actuator cables. Even difficult-to-reach round plugs are accessible using the Screwty®. A simple turning movement tightens and loosens the connectors without the need for excessive force. The Screwty® is a unique and global solution since it fits with most cables and plugs from other vendors (over 90 %). The Screwty® consists of a handle with a conventional 1/4" adapter. Thus it can be used for all sizes: for M12 and M8 round plug-in connectors, and for M12F and M8F customisable plugs and sockets, as well as for all M23 plugs and sockets.

General ordering data

Type	SCREWTY- M12	Version	Packaging
Order No.	1900000000	Cable gland tool for moulded M12 lines	Cardboard box
GTIN (EAN)	4032248375868		
Qty.	1 pc(s).		
Type	SCREWTY SET	Version	Packaging
Order No.	1910000000	Cable gland tool for M8, M12 lines and connectors	Cardboard box
GTIN (EAN)	4032248436842		
Qty.	1 pc(s).		

Screwty® cable gland tool with torque function



The ideal tool for any application

Screwty® is the ideal, all-purpose tool for tightening all common sensor and actuator cables. Even difficult-to-reach round plugs are accessible using the Screwty®. A simple turning movement tightens and loosens the connectors without the need for excessive force. The Screwty® is a unique and global solution since it fits with most cables and plugs from other vendors (over 90 %). The Screwty® consists of a handle with a conventional 1/4" adapter. Thus it can be used for all sizes: for M12 and M8 round plug-in connectors, and for M12F and M8F customisable plugs and sockets, as well as for all M23 plugs and sockets.

General ordering data

Type	SCREWTY SET -DM	Version	Packaging
Order No.	1920000000	Cable gland tool for M8, M12 lines and connectors	Cardboard box
GTIN (EAN)	4032248436859		
Qty.	1 pc(s).		
Type	SCREWTY-M12-DM	Version	Packaging
Order No.	1900001000	Cable gland tool for moulded M12 lines	Cardboard box
GTIN (EAN)	4032248436408		
Qty.	1 pc(s).		

IE-C5DD4UG0500MCSA70-E**Weidmüller Interface GmbH & Co. KG**

Klingenbergstraße 26

D-32758 Detmold

Germany

www.weidmueller.com**Accessories****Blank**

TM-I is an acknowledged and accredited marker type for traffic engineering applications. There are various different tag lengths available for individual labelling with long character strings. Easy handling of separation and installation thanks to the project marker field. Pre-attachment of sleeves and retrofitting of tags offer excellent versatility

The special contour of TM-I allows easy assembly and secures firm positioning. They are compatible with a number of commercially available sleeves. Thanks to the MultiCard format, the tags can be printed quickly and conveniently with the PrintJet CONNECT, plotter or the STI pen.

- Easy handling of separation and installation thanks to the project marker field.
- Acknowledged and accredited marker for traffic engineering applications
- Pre-attachment of sleeves and retrofitting of tags offer excellent versatility
- Not suited for labelling with P-Ink or STI pen in connection with CLI T sleeves

For custom printing: Please send us a file of our labeling software M-Print PRO or M-Print PRO Online (without installation) for your labeling specifications.

General ordering data

Type	TM-I 18 MC NE WS	Version
Order No.	1718431044	TM-I, Insert markers, 18 x 4 mm, white
GTIN (EAN)	4008190349011	
Qty.	320 pc(s).	

IE-C5DD4UG0500MCSA70-E**Weidmüller Interface GmbH & Co. KG**

Klingenbergstraße 26

D-32758 Detmold

Germany

www.weidmueller.com**Accessories****Blank**

TM-I is an acknowledged and accredited marker type for traffic engineering applications. There are various different tag lengths available for individual labelling with long character strings. Easy handling of separation and installation thanks to the project marker field. Pre-attachment of sleeves and retrofitting of tags offer excellent versatility

The special contour of TM-I allows easy assembly and secures firm positioning. They are compatible with a number of commercially available sleeves. Thanks to the MultiCard format, the tags can be printed quickly and conveniently with the PrintJet CONNECT, plotter or the STI pen.

- Easy handling of separation and installation thanks to the project marker field.
- Acknowledged and accredited marker for traffic engineering applications
- Pre-attachment of sleeves and retrofitting of tags offer excellent versatility
- Not suited for labelling with P-Ink or STI pen in connection with CLI T sleeves

For custom printing: Please send us a file of our labeling software M-Print PRO or M-Print PRO Online (without installation) for your labeling specifications.

General ordering data

Type	TM-I 12 MC NE WS	Version
Order No.	1718411044	TM-I, Insert markers, 12 x 4 mm, white
GTIN (EAN)	4008190348977	
Qty.	320 pc(s).	