

HDC 10A ALU SL**Weidmüller Interface GmbH & Co. KG**

Klingenbergstraße 26

D-32758 Detmold

Germany

www.weidmueller.com**IP65**

The special die-cast alloy and the multi-layered surface sealing provide complete protection for the HDC housings.

The cleverly designed interlock system is manufactured from stainless steel. This guarantees a long lifespan with high resistance to corrosion and impact.

The housing interlock system provides integrated safety. Our unique, patented spring system provides the housing interlock with a secure grip and prevents accidental opening.

The laser marking allows for easy and quick identification. Each housing is permanently labelled with a laser marking so that each product can be quickly designated and positioned.

Weidmüller RockStar® IP 65 / NEMA Type 4X housings - your first choice for industrial housings with IP 65 protection.

General ordering data

Version	HDC enclosures, Size: 2, Protection degree: IP65 (in plugged condition), Bulkhead housing, End-locking clamp, lower side, Standard
Order No.	1021450000
Type	HDC 10A ALU SL
GTIN (EAN)	4032248734962
Qty.	1 pc(s).

HDC 10A ALU SL

Weidmüller Interface GmbH & Co. KG

Klingenbergstraße 26

D-32758 Detmold

Germany

www.weidmueller.com

Technical data

Dimensions and weights

Depth	84 mm	Depth (inches)	3.307 inch
Height	26 mm	Height (inches)	1.024 inch
Width	52.5 mm	Width (inches)	2.067 inch
Mounting dimension - height	17.5 mm	Mounting dimension - width	70 mm
Net weight	69 g		

Temperatures

Limit temperature	-40 °C ... 125 °C
-------------------	-------------------

Dimensions

Height of base B1	5 mm	Height of housing B	26 mm
Hole pitch length A2	70 mm	Total length housing	63 mm
Width base C1	33 mm	Width housing C	29.5 mm

General data

EMC housings	No	Housing main material	diecast aluminium
Material of locking element	Stainless steel, rust-proof	Protection degree	IP65 (in plugged condition)
Surface finish	Powder coating	Tightening torque	0.5 Nm

Version

BG	2	Clamp version	End-locking clamp
Colour (RAL)	RAL 7035	Design	Standard
Design of housing	Bulkhead housing	Design of locking system	End-locking clamp, lower side
Sealing	NBR	Size	2
Suitable for ModuPlug®	No	Tightening torque	0.5 Nm
Top part/bottom part/lid	lower part	Type	Bulkhead (feed-through)

Classifications

ETIM 6.0	EC000437	ETIM 7.0	EC000437
ETIM 8.0	EC000437	ETIM 9.0	EC000437
ECLASS 9.0	27-44-02-02	ECLASS 9.1	27-44-02-02
ECLASS 10.0	27-44-02-02	ECLASS 11.0	27-44-02-02
ECLASS 12.0	27-44-02-02	ECLASS 13.0	27-44-02-02

Substance	Acetone
Chemical resistance	Conditionally resistant
Substance	Drilling oil
Chemical resistance	Resistant
Substance	Diesel
Chemical resistance	Resistant
Substance	Ethyl alcohol
Chemical resistance	Resistant
Substance	Transmission oil
Chemical resistance	Resistant

Creation date July 5, 2024 2:27:29 AM CEST

HDC 10A ALU SL**Weidmüller Interface GmbH & Co. KG**

Klingenbergstraße 26

D-32758 Detmold

Germany

www.weidmueller.com

Technical data

Substance	Hydraulic oil
Chemical resistance	Resistant
Substance	Coolant
Chemical resistance	Resistant
Substance	Petroleum benzine
Chemical resistance	Resistant
Substance	Sweat
Chemical resistance	Resistant
Substance	Premium gasoline
Chemical resistance	Conditionally resistant
Substance	Water
Chemical resistance	Resistant
Substance	UV
Chemical resistance	Unstable
Substance	Ozone
Chemical resistance	Unstable

Environmental Product Compliance

REACH SVHC	Lead 7439-92-1
SCIP	d447edfa-0214-4f34-b5ba-82eae491b46a
Chemical resistance	de.myview.objectmodel.impl.BlockImpl@1054fb46 de.myview.objectmodel.impl.BlockImpl@2857dbcd de.myview.objectmodel.impl.BlockImpl@77428e38 de.myview.objectmodel.impl.BlockImpl@70a7a576 de.myview.objectmodel.impl.BlockImpl@479efeef de.myview.objectmodel.impl.BlockImpl@5101cc62 de.myview.objectmodel.impl.BlockImpl@32d1bb34 de.myview.objectmodel.impl.BlockImpl@7f90340d de.myview.objectmodel.impl.BlockImpl@4f49d496 de.myview.objectmodel.impl.BlockImpl@107473c1 de.myview.objectmodel.impl.BlockImpl@2f4372e0 de.myview.objectmodel.impl.BlockImpl@518d0b59 de.myview.objectmodel.impl.BlockImpl@50e1889a

Important note

Product information	When mounting the housings, make sure that the flat gasket is correctly seated.
---------------------	---

Approvals

Approvals



ROHS	Conform
------	---------

Downloads

Approval/Certificate/Document of Conformity	Manufacturer's declaration
Engineering Data	CAD data – STEP
Product Change Notification	20220214 Technical change to HDC housings 20220214 Technische Änderung bei HDC-Gehäusen
Catalogues	Catalogues in PDF-format
Brochures	FL FIELDWIRING EN FL FIELDWIRING EN

Creation date July 5, 2024 2:27:29 AM CEST

Catalogue status 29.06.2024 / We reserve the right to make technical changes.

HDC 10A ALU SL

Weidmüller Interface GmbH & Co. KG
Klingenbergstraße 26
D-32758 Detmold
Germany

www.weidmueller.com

Drawings

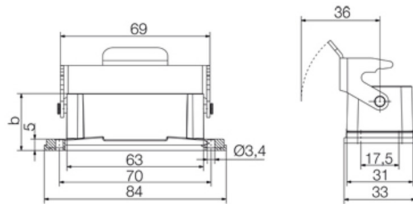

HDC 10A ALU SL**Weidmüller Interface GmbH & Co. KG**

Klingenbergstraße 26

D-32758 Detmold

Germany

www.weidmueller.com**Accessories****Cover**

The special die-cast alloy and the multi-layered surface sealing provide complete protection for the HDC housings.

The cleverly designed interlock system is manufactured from stainless steel. This guarantees a long lifespan with high resistance to corrosion and impact.

The housing interlock system provides integrated safety. Our unique, patented spring system provides the housing interlock with a secure grip and prevents accidental opening.

The laser marking allows for easy and quick identification. Each housing is permanently labelled with a laser marking so that each product can be quickly designated and positioned.

Weidmüller RockStar® IP 65 / NEMA Type 4X housings - your first choice for industrial housings with IP 65 protection.

General ordering data

Type	HDC 10A DMDL 2BO	Version
Order No.	1665880000	HDC enclosures, Size: 2, Protection degree: IP65 (in plugged
GTIN (EAN)	4008190422912	condition), Cover for lower part of housing, End-locking clamp, lower
Qty.	1 pc(s).	side, Standard