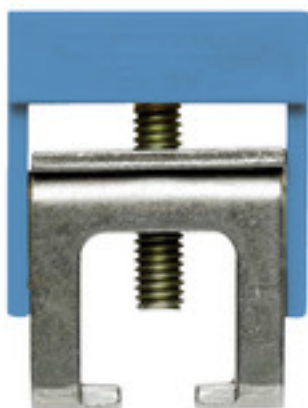

ZBE 6K BL**Weidmüller Interface GmbH & Co. KG**

Klingenbergstraße 26

D-32758 Detmold

Germany

www.weidmueller.com**Product image**

Bus bar taps with insulation offer finger safety on the one hand. On the other hand, the colored insulation also indicates the respective potential, such as the neutral conductor or PE.

General ordering data

Version	Clamping yoke (bus-bar)
Order No.	0525980000
Type	ZBE 6K BL
GTIN (EAN)	4008190060886
Qty.	50 pc(s).

ZBE 6K BL**Weidmüller Interface GmbH & Co. KG**

Klingenbergstraße 26

D-32758 Detmold

Germany

www.weidmueller.com**Technical data****Dimensions and weights**

Depth	19.5 mm	Depth (inches)	0.768 inch
Height	22.5 mm	Height (inches)	0.886 inch
Width	8 mm	Width (inches)	0.315 inch
Net weight	2.98 g		

Temperatures

Operating temperature range	For operating temperature range see EC Design Test Certificate / IEC Ex-Certificate of Conformity
-----------------------------	---

Material data

Material	Steel	Insulating material	PA
Colour	blue		

ZBE 6K BL**Weidmüller Interface GmbH & Co. KG**

Klingenbergstraße 26

D-32758 Detmold

Germany

www.weidmueller.com

Technical data**Rating data IECEx/ATEX**

Certificate No. (ATEX)	DEMKO03ATEX136028U	Certificate No. (IECEX)	IECEXULD13.0005U
Wire cross section max. (ATEX)	6 mm ²	Wire cross section max. (IECEX)	6 mm ²
Operating temperature range	For operating temperature range see EC Design Test Certificate / IEC Ex-Certificate of Conformity	Marking EN 60079-7	
Ex 2014/34/EU label		Safety notice	<p>Ex eb II C Gb</p> <p>Installation instructions: The potential equalisation (PE) rail modules are suitable for use in housings in atmospheres with flammable gases and dust. For use in areas with flammable gases, these housings must meet the requirements of EN 60079-0 and EN 60079-7. For use in areas with flammable dust, these housings must meet the requirements of EN 60079-0 and EN 60079-31.</p> <p>When combined with other terminal block ranges and sizes, and when other accessories are used, you must comply with the clearance and creepage distances given.</p> <p>Regarding accessory use, the manufacturer's instructions must be followed.</p> <p>List of restrictions: The PE rail modules are considered one component, with Ex marking when used with the busbar holders of type SH and WEW. When used independently, the above named components are not covered by this certificate.</p>
II 2 G D			

System specifications

Version for busbar 10 x 3 mm

Additional technical data

Installation advice	Busbar, Direct mounting	Type of mounting	when screwed in
---------------------	-------------------------	------------------	-----------------

CSA rating data

Certificate No. (CSA)	12400-237	Wire cross section max. (CSA)	8 AWG
Wire cross section min. (CSA)	22 AWG		

ZBE 6K BL**Weidmüller Interface GmbH & Co. KG**

Klingenbergstraße 26

D-32758 Detmold

Germany

www.weidmueller.com

Technical data**Conductors for clamping (rated connection)**

Clamping screw	M 4	Stripping length	19 mm
Tightening torque, min.	1.2 Nm	Type of connection	Clamping yoke
Wire connection cross section, finely stranded, max.	10 mm ²	Wire connection cross section, finely stranded, min.	1.5 mm ²
Wire connection cross-section, solid core, max.	10 mm ²	Wire connection cross-section, solid core, min.	1 mm ²

Dimensions

TS 35 offset	41 mm
--------------	-------

General

Installation advice	Busbar, Direct mounting
---------------------	-------------------------

Rating data

Rated cross-section	6 mm ²
---------------------	-------------------

Classifications

ETIM 6.0	EC002848	ETIM 7.0	EC002848
ETIM 8.0	EC002848	ETIM 9.0	EC002848
ECLASS 9.0	27-14-11-92	ECLASS 9.1	27-14-11-92
ECLASS 10.0	27-14-11-92	ECLASS 11.0	27-14-11-46
ECLASS 12.0	27-14-11-46	ECLASS 13.0	27-25-01-16

Environmental Product Compliance

REACH SVHC	/
------------	---

Approvals

Approvals



ROHS	Conform
------	---------

Downloads

Approval/Certificate/Document of Conformity	Attestation of Conformity UKCA Attestation of conformity ATEX Certificate IECEX Certificate UKCA Certificate
Engineering Data	CAD data – STEP
User Documentation	Installation Instruction StorageConditionsTerminalBlocks NTI ZB WBBB
Catalogues	Catalogues in PDF-format